

ADDENDUM NO. 2

TO THE PLANS AND SPECIFICATIONS FOR:

JFSB 2024 CNA Remodel Office Suites 1041 & 1053

Prepared by

Brigham Young University
Planning & Construction Dept.
240 Brewster Physical Plant
Provo, Utah 84602
14 March 2024

This Addendum issued 14 March 2024 is for all persons preparing bids and as such shall be made a part of the contract documents. This Addendum consists of this cover sheet and 34 pages. In case of any conflict between the drawings, specifications, and this Addendum, this Addendum shall govern. All changes, corrections, deletions and/or additions to the initial bidding documents shall be included in the Bidder's proposal. Receipt of this Addendum shall be acknowledged on the Bid proposal forms.

Approved by:

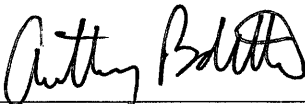

Anthony R. Burdette, Director of Construction

14 March 2024

Date

**2024 - CNA (JSFB) Joseph Fielding Smith Building
Interior Remodel of Office Suite 1041 and Suite 1053
Work Order - #M8101**

ADDENDUM NO. 2 – 03/14/2024

General Information:

1. As a matter of clarification, the building floor to floor distance is 19'-8".
2. As a matter of clarification, the fire alarm devices have been noted on the demolition and the new electrical plans.
3. As a matter of clarification, See attached Asbestos Survey. It is for "Reference only" and is to be kept on sight by the general contractor and provided to any State or BYU inspector upon request. General contractor is responsible to understand the report. The owner will remove any asbestos on the project. If the general contractor or any of its subcontractors encounter any suspicious or known asbestos during the project, they are to notify BYU immediately and BYU will have it removed. It will be removed by a qualified asbestos abatement contractor. There was no asbestos found.
4. As a matter of clarification, the existing front desk and the student cubical area are to be removed by BYU moving – see attached demolition plan.
5. As a matter of clarification, the contractor shall stage the supplies and equipment in the construction area during the project. If there is a need for additional storage space we will designate a location.
6. As a matter of clarification, the raised floor access system is manufactured by Tate, Inc. The existing floor tiles are a 24"x 24" concrete filled panel. The contractor will need to order 80 floor panels to replace the ones to be removed.

Drawing Information:

7. As a matter of clarification, the existing front desk and the student cubical area are to be removed by BYU moving – see attached demolition plan.



**226 East 4800 South
Murray, Utah 84107
Phone 385-321-9701**

AN ASBESTOS SURVEY AND ASSESSMENT FOR



**BYU
Joseph F. Smith Building
1100 Campus Drive
Provo, Utah, 84604
March 12, 2024**

**Prepared by:
Scott Bainbridge #ASB-6822
Annabelle Mitchell #ASB-8012
Air Quality Consulting, LLC #603**

**385-321-9701
scott@airqualityconsult.com**

Executive Summary

Asbestos-containing material (ACM) was not found in any of the tested suspect locations.

Assume all fire doors until destructive testing can be performed.

* - Denotes less than 1% asbestos which is regulated by OSHA, it is recommended to review their regulations before removal

Building Description

Structure: Wood or Metal Framed

Roof: Not Inspected

Siding: Brick, Glass, Concrete

Foundation: Concrete

Insulation: Fiberglass

Walls: Drywall

Ceiling: Ceiling Panel

Flooring: Carpet, Vinyl Tile

Non-ACM Results by Material

Sample Number	MaterialDescription/Lab Results	Amount	Homogeneous Area
Ceiling Panel			
JFSB-3724-1	2x2 Smooth Ceiling Panel/None detected	4,500 sf	1st floor
JFSB-3724-2	2x2 Smooth Ceiling Panel/None detected	4,500 sf	1st floor
JFSB-3724-3	2x2 Smooth Ceiling Panel/None detected	4,500 sf	1st floor
JFSB-3724-4	2x2 Smooth Ceiling Panel/None detected	4,500 sf	1st floor
JFSB-3724-5	2x2 Smooth Ceiling Panel/None detected	4,500 sf	1st floor
			
JFSB-3724-13	2x4 Worm Hole Ceiling Panel	15,000 sf	Throughout
JFSB-3724-14	2x4 Worm Hole Ceiling Panel	15,000 sf	Throughout
JFSB-3724-32	2x4 Worm Hole Ceiling Panel	15,000 sf	Throughout
JFSB-3724-33	2x4 Worm Hole Ceiling Panel	15,000 sf	Throughout
JFSB-3724-46	2x4 Worm Hole Ceiling Panel	15,000 sf	Throughout
JFSB-3724-47	2x4 Worm Hole Ceiling Panel	15,000 sf	Throughout
JFSB-3724-51	2x4 Worm Hole Ceiling Panel	15,000 sf	Throughout
JFSB-3724-52	2x4 Worm Hole Ceiling Panel	15,000 sf	Throughout
Sample Number	MaterialDescription/Lab Results	Amount	Homogeneous Area
TSI			
JFSB-3724-6	TSI/None detected	750 Ln ft	Throughout
JFSB-3724-19	TSI/None detected	750 Ln ft	Throughout

JFSB-3724-29	TSI/None detected	750 Ln ft	Throughout
--------------	-------------------	-----------	------------



Sample Number	MaterialDescription/Lab Results	Amount	Homogeneous Area
---------------	---------------------------------	--------	------------------

Cove Base			
------------------	--	--	--

JFSB-3724-7	4" Tan Cove Base/None detected	150 sf	Custodial
JFSB-3724-31	4" Tan Cove Base/None detected	150 sf	Custodial
JFSB-3724-41	4" Tan Cove Base/None detected	150 sf	Custodial
JFSB-3724-45	4" Tan Cove Base/None detected	150 sf	Custodial
JFSB-3724-50	4" Tan Cove Base/None detected	150 sf	Custodial
JFSB-3724-55	4" Tan Cove Base/None detected	150 sf	Custodial



Sample Number	MaterialDescription/Lab Results	Amount	Homogeneous Area
---------------	---------------------------------	--------	------------------

Vinyl Tile			
-------------------	--	--	--

JFSB-3724-8	12"x12" Tan Vinyl Tile/None Detected	1,500 sf	Custodial, Basement Labs
JFSB-3724-30	12"x12" Tan Vinyl Tile/None Detected	1,500 sf	Custodial, Basement Labs
JFSB-3724-35	12"x12" Tan Vinyl Tile/None Detected	1,500 sf	Custodial, Basement Labs

JFSB-3724-42	12"x12" Tan Vinyl Tile/None Detected	1,500 sf	Custodial, Basement Labs
JFSB-3724-44	12"x12" Tan Vinyl Tile/None Detected	1,500 sf	Custodial, Basement Labs
JFSB-3724-49	12"x12" Tan Vinyl Tile/None Detected	1,500 sf	Custodial, Basement Labs
JFSB-3724-54	12"x12" Tan Vinyl Tile/None Detected	1,500 sf	Custodial, Basement Labs



JFSB-3724-27	2'x2' Beige Vinyl Tile/None Detected	200 sf	Stairwells
JFSB-3724-28	2'x2' Beige Vinyl Tile/None Detected	200 sf	Stairwells



Sample Number	MaterialDescription/Lab Results	Amount	Homogeneous Area
Drywall System			
JFSB-3724-9	Drywall System/None Detected	50,000 sf	Throughout
JFSB-3724-10	Drywall System/None Detected	50,000 sf	Throughout
JFSB-3724-11	Drywall System/None Detected	50,000 sf	Throughout
JFSB-3724-12	Drywall System/None Detected	50,000 sf	Throughout

JFSB-3724-37	Drywall System/None Detected	50,000 sf	Throughout
JFSB-3724-38	Drywall System/None Detected	50,000 sf	Throughout
JFSB-3724-39	Drywall System/None Detected	50,000 sf	Throughout
JFSB-3724-40	Drywall System/None Detected	50,000 sf	Throughout
JFSB-3724-43	Drywall System/None Detected	50,000 sf	Throughout
JFSB-3724-48	Drywall System/None Detected	50,000 sf	Throughout
JFSB-3724-53	Drywall System/None Detected	50,000 sf	Throughout
JFSB-3724-56	Drywall System/None Detected	50,000 sf	Throughout
JFSB-3724-57	Drywall System/None Detected	50,000 sf	Throughout
Sample Number	MaterialDescription/Lab Results	Amount	Homogeneous Area
Concrete			
JFSB-3724-15	False Floor Concrete/None Detected	100 sf	1151
JFSB-3724-16	False Floor Concrete/None Detected	100 sf	1151
			
Sample Number	MaterialDescription/Lab Results	Amount	Homogeneous Area
Floor Glue			
JFSB-3724-	Floor Glue/None Detected	100 sf	1151
JFSB-3724-	Floor Glue/None Detected	100 sf	1151



Sample Number	MaterialDescription/Lab Results	Amount	Homogeneous Area
Mudded Elbows			
JFSB-3724-20	Mudded Elbow/None Detected	10 elbows	Mechanical
JFSB-3724-24	Mudded Elbow/None Detected	10 elbows	Mechanical
Sample Number	MaterialDescription/Lab Results	Amount	Homogeneous Area
Fire Proofing			
JFSB-3724-21	Fire Proofing/None Detected	1,500 sf	Mechanical
JFSB-3724-22	Fire Proofing/None Detected	1,500 sf	Mechanical
JFSB-3724-23	Fire Proofing/None Detected	1,500 sf	Mechanical
JFSB-3724-25	Fire Proofing/None Detected	1,500 sf	Mechanical
JFSB-3724-26	Fire Proofing/None Detected	1,500 sf	Mechanical



Utah Asbestos Sampling Worksheet

Facility name, address:	Joseph F. Smith Building, BYU
Scope:	Test all suspect ACM for renovation
Anticipation of work:	Collect samples of all homogenous, suspect materials

Suspect ACM	Quantity	Location	Sampled/ Assumed	RACM/ CAT 1/ CAT 2
JFSB-3724-1-2x2 Smooth Ceiling Panel	4,500 sf	1031	Sampled	ND
JFSB-3724-2-2x2 Smooth Ceiling Panel	4,500 sf	1041	Sampled	ND
JFSB-3724-3-2x2 Smooth Ceiling Panel	4,500 sf	1063	Sampled	ND
JFSB-3724-4-2x2 Smooth Ceiling Panel	4,500 sf	1131	Sampled	ND
JFSB-3724-5-2x2 Smooth Ceiling Panel	4,500 sf	1163	Sampled	ND
JFSB-3724-6-TSI	75 Ln ft	1st floor hallway	Sampled	ND
JFSB-3724-7-4" Tan Cove Base and Mastic	150 sf	1021	Sampled	ND
JFSB-3724-8-12x12 Tan Vinyl Tile and Mastic	500 sf	1021	Sampled	ND
JFSB-3724-9-Drywall System	50,000 sf	B 163A	Sampled	ND
JFSB-3724-10-Drywall System	50,000 sf	B 003A	Sampled	ND
JFSB-3724-11-Drywall System	50,000 sf	Basement Hall	Sampled	ND
JFSB-3724-12-Drywall System	50,000 sf	Basement Hall	Sampled	ND
JFSB-3724-13-2x4 Worm Hole Ceiling Panel	15,000 sf	Basement Hall	Sampled	ND
JFSB-3724-14-2x4 Worm Hole Ceiling Panel	15,000 sf	Basement Hall	Sampled	ND
JFSB-3724-15-False Floor Concrete	100 sf	1151	Sampled	ND
JFSB-3724-16-False Floor Concrete	100 sf	1151	Sampled	ND
JFSB-3724-17-Floor Glue	100 sf	1151	Sampled	ND
JFSB-3724-18-Floor Glue	100 sf	1151	Sampled	ND
JFSB-3724-19-TSI	75 Ln ft	Mechanical basement	Sampled	ND
JFSB-3724-20-Mudded Elbow	10 elbows	Mechanical basement	Sampled	ND
JFSB-3724-21-Fire Proofing	1,500 sf	Mechanical basement	Sampled	ND
JFSB-3724-22-Fire Proofing	1,500 sf	Mechanical basement	Sampled	ND
JFSB-3724-23-Fire Proofing	1,500 sf	Mechanical basement	Sampled	ND
JFSB-3724-24-Mudded Elbow	10 elbows	Mechanical basement	Sampled	ND
JFSB-3724-25-Fire Proofing	1,500 sf	Mechanical basement	Sampled	ND
JFSB-3724-26-Fire Proofing	1,500 sf	Mechanical basement	Sampled	ND
JFSB-3724-27-2x2 Beige Vinyl Tile	200 sf	Stairwell	Sampled	ND
JFSB-3724-28-2x2 Beige Vinyl Tile	200 sf	Stairwell	Sampled	ND
JFSB-3724-29-TSI	75 Ln Ft	2nd floor Bathroom chase	Sampled	ND
JFSB-3724-30-12x12 Tan Vinyl Tile and Mastic	500 sf	2028	Sampled	ND
JFSB-3724-31-4" Tan Cove Base	150 sf	2028	Sampled	ND
JFSB-3724-32-2x4 Worm Hole Ceiling Panel	15,000 sf	2nd floor hallway	Sampled	ND
JFSB-3724-33-2x4 Worm Hole Ceiling Panel	15,000 sf	2nd floor hallway	Sampled	ND
JFSB-3724-34-Drywall System	50,000 sf	2028	Sampled	ND
JFSB-3724-35-12x12 Tan Vinyl Tile and Mastic	500 sf	2170	Sampled	ND
JFSB-3724-36-4" Tan Cove Base and Mastic	150 sf	2170	Sampled	ND
JFSB-3724-37-Drywall System	50,000 sf	2170	Sampled	ND
JFSB-3724-38-Drywall System	50,000 sf	2102 E	Sampled	ND
JFSB-3724-39-Drywall System	50,000 sf	2042	Sampled	ND
JFSB-3724-40-Drywall System	50,000 sf	3170	Sampled	ND

JFSB-3724-41-4" Tan Cove Base and Mastic	150 sf	3170	Sampled	ND
JFSB-3724-42-12x12 Tan Vinyl Tile and Mastic	500 sf	3170	Sampled	ND
JFSB-3724-43-Drywall System	50,000 sf	3070	Sampled	ND
JFSB-3724-44-12x12 Tan Vinyl Tile and Mastic	500 sf	3070	Sampled	ND
JFSB-3724-45-4" Tan Cove Base and Mastic	150 sf	3070	Sampled	ND
JFSB-3724-46-2x4 Worm Hole Ceiling Panel	15,000 sf	3rd floor hallway	Sampled	ND
JFSB-3724-47-2x4 Worm Hole Ceiling Panel	15,000 sf	3rd floor hallway	Sampled	ND
JFSB-3724-48-Drywall System	50,000 sf	4170	Sampled	ND
JFSB-3724-49-12x12 Tan Vinyl Tile and Mastic	500 sf	4170	Sampled	ND
JFSB-3724-50-4" Tan Cove Base and Mastic	150 sf	4170	Sampled	ND
JFSB-3724-51-2x4 Worm Hole Ceiling Panel	15,000 sf	4th floor hallway	Sampled	ND
JFSB-3724-52-2x4 Worm Hole Ceiling Panel	15,000 sf	4th floor hallway	Sampled	ND
JFSB-3724-53-Drywall System	50,000 sf	4070	Sampled	ND
JFSB-3724-54-12x12 Tan Vinyl Tile and Mastic	500 sf	4070	Sampled	ND
JFSB-3724-55-4" Tan Cove Base and Mastic	150 sf	4070	Sampled	ND
JFSB-3724-56-Drywall System	50,000 sf	4990	Sampled	ND
JFSB-3724-57-Drywall System	50,000 sf	4990	Sampled	ND
Laboratory Analysis PLM/PCM/TEM		PLM		
Inaccessible areas of suspect ACM		Under concrete foundation		
Anabelle Mitchell Cert #ASB-8012				
			March 12, 2024	

* - Denotes less than 1% asbestos which is regulated by OSHA, it is recommended to review their regulations before removal

JFSB-24
Sample Locations

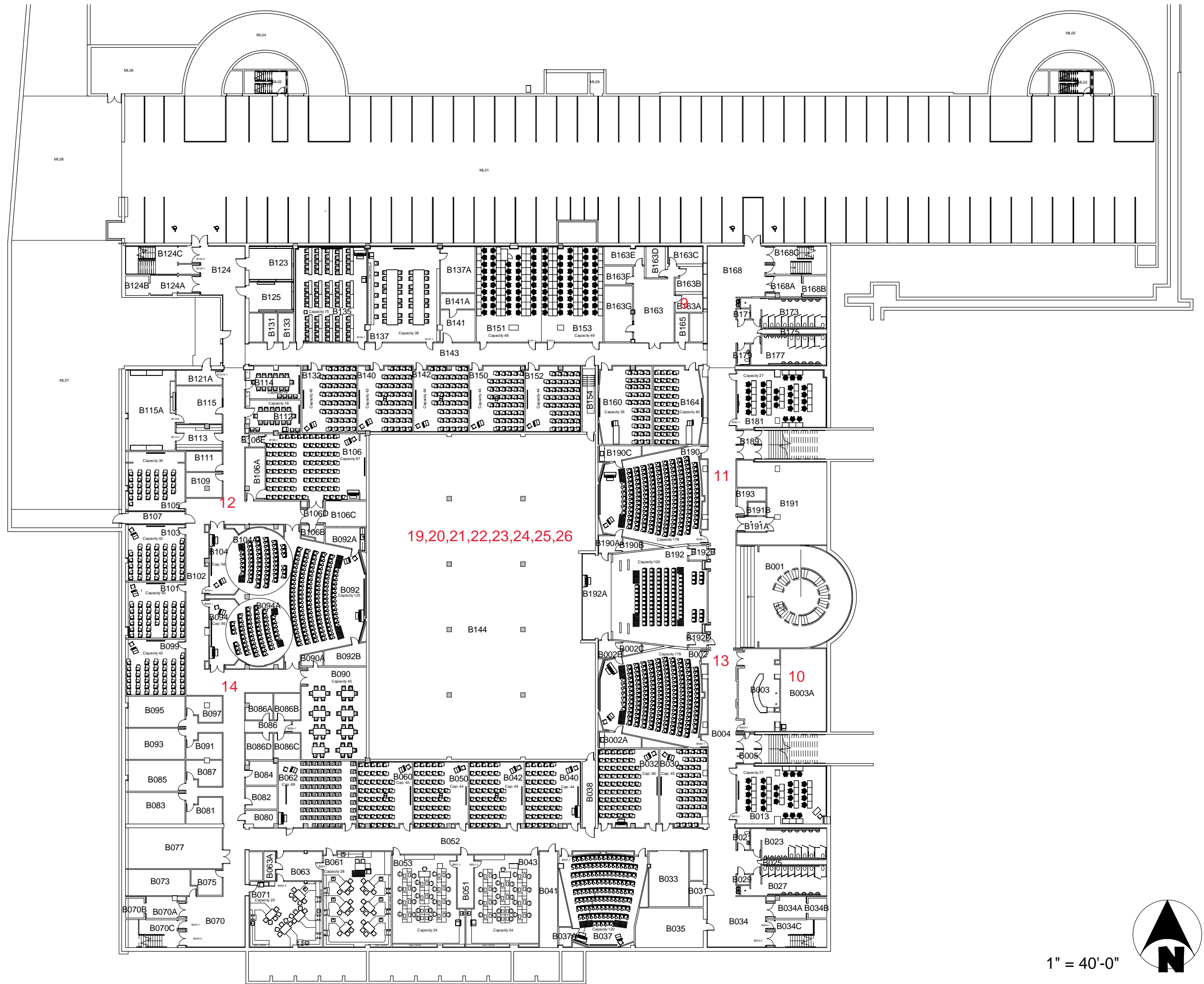

1" = 40'-0"

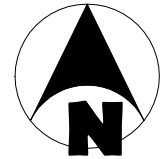

JFSB-3724
Sampling Locations

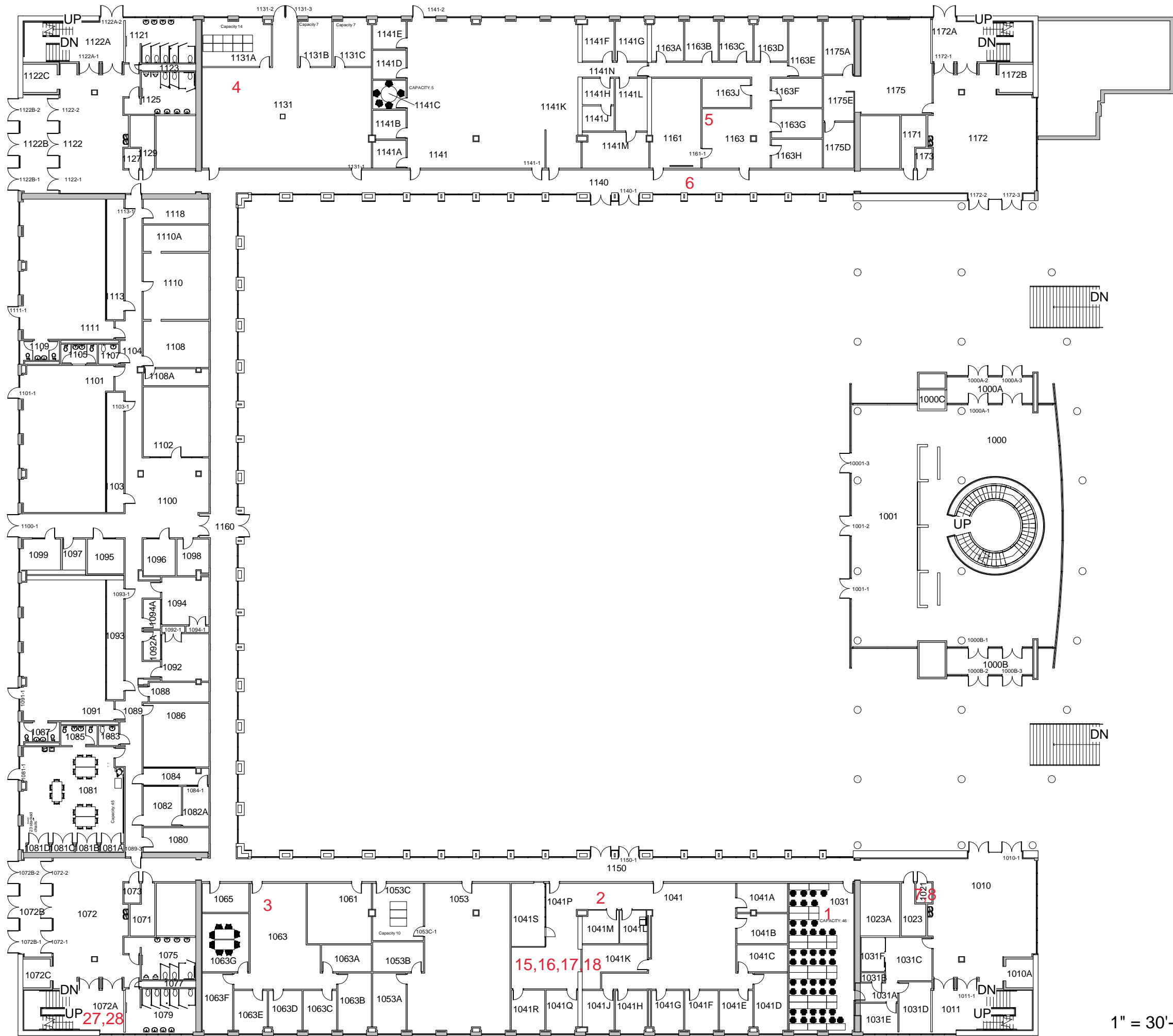

1" = 30'-0"



JFSB
1st Floor

BRIGHAM YOUNG
UNIVERSITY

FACILITIES PLANNING
REVIT DATABASE
9/9/2022
8:48:27 AM
240 BRWB PROVO, UT 84602
PHONE: (801) 422-5504

JFSB-3724
Sample Locations

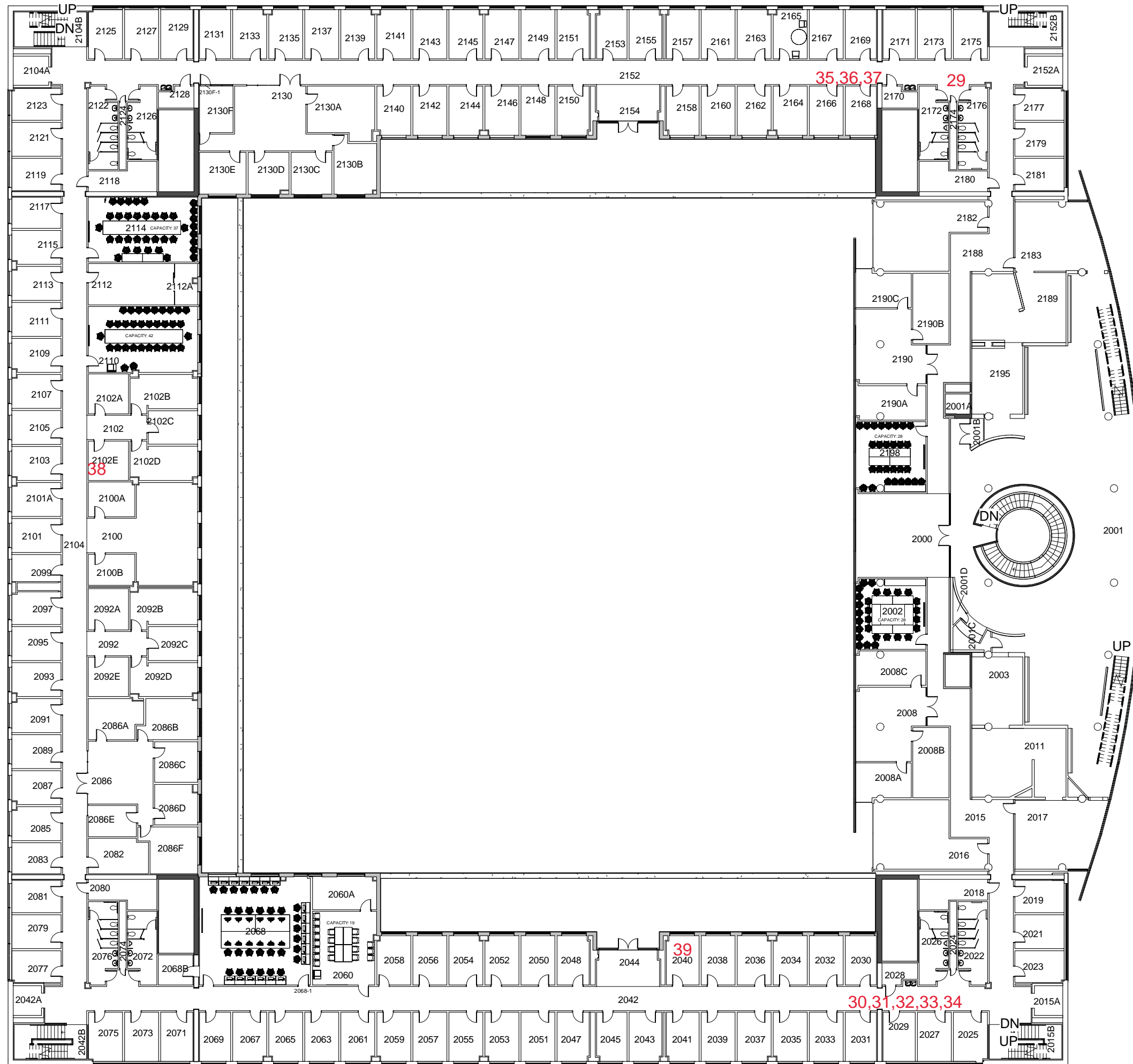

1" = 30'-0"



JFSB
2nd Floor

BRIGHAM YOUNG
UNIVERSITY

FACILITIES PLANNING
REVIT DATABASE
8/10/2023
240 BRWB PROVO, UT 84602
PHONE: (801) 422-5504
10:47:52 AM

JFSB-3724
Sample Locations

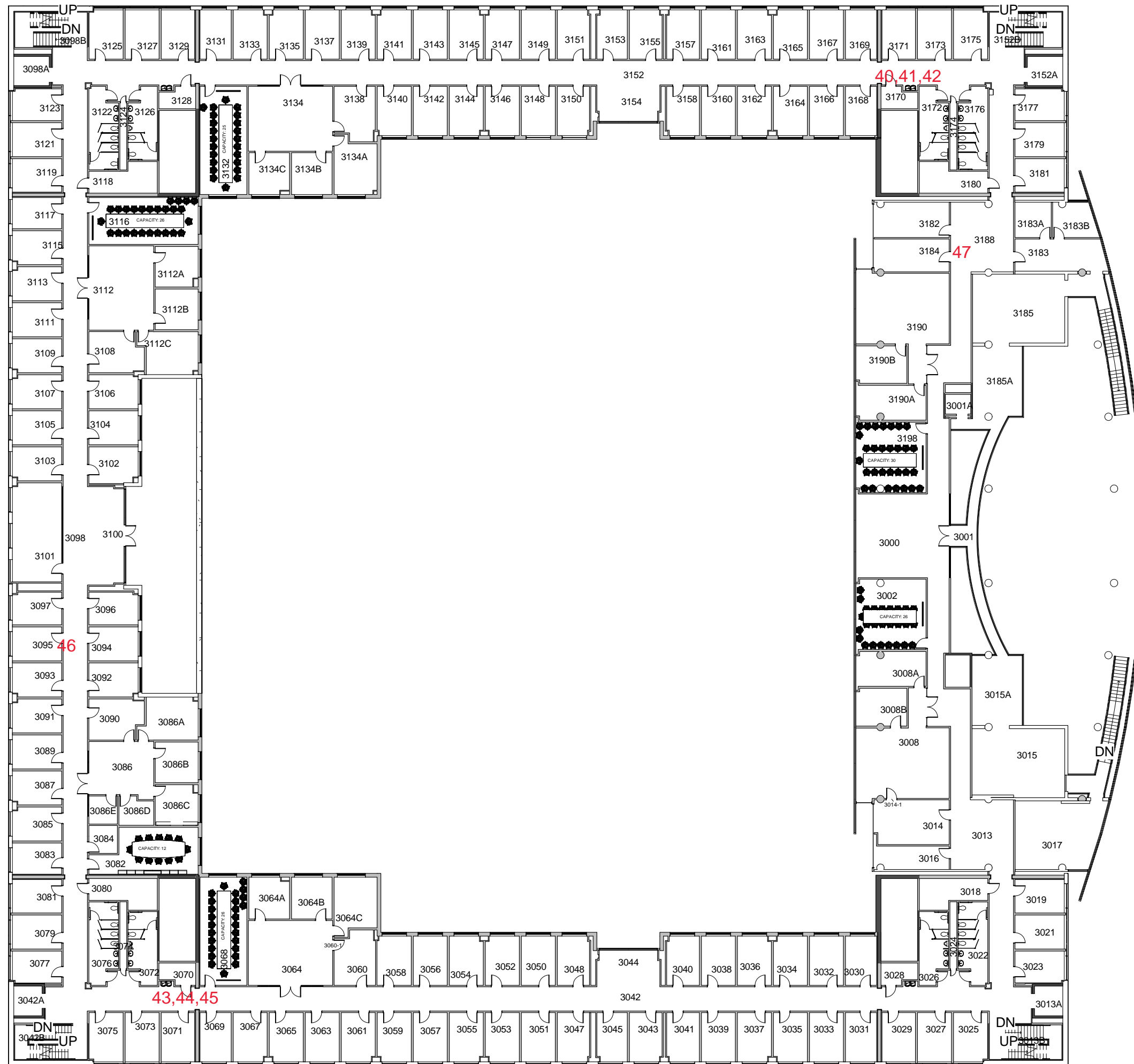

1" = 30'-0"



JFSB
3rd Floor

BRIGHAM YOUNG
UNIVERSITY

FACILITIES PLANNING
REVIT DATABASE
7/27/2023
9:44:15 AM
240 BRWB PROVO, UT 84602
PHONE: (801) 422-5504

JFSB-3724
Sampling Locations

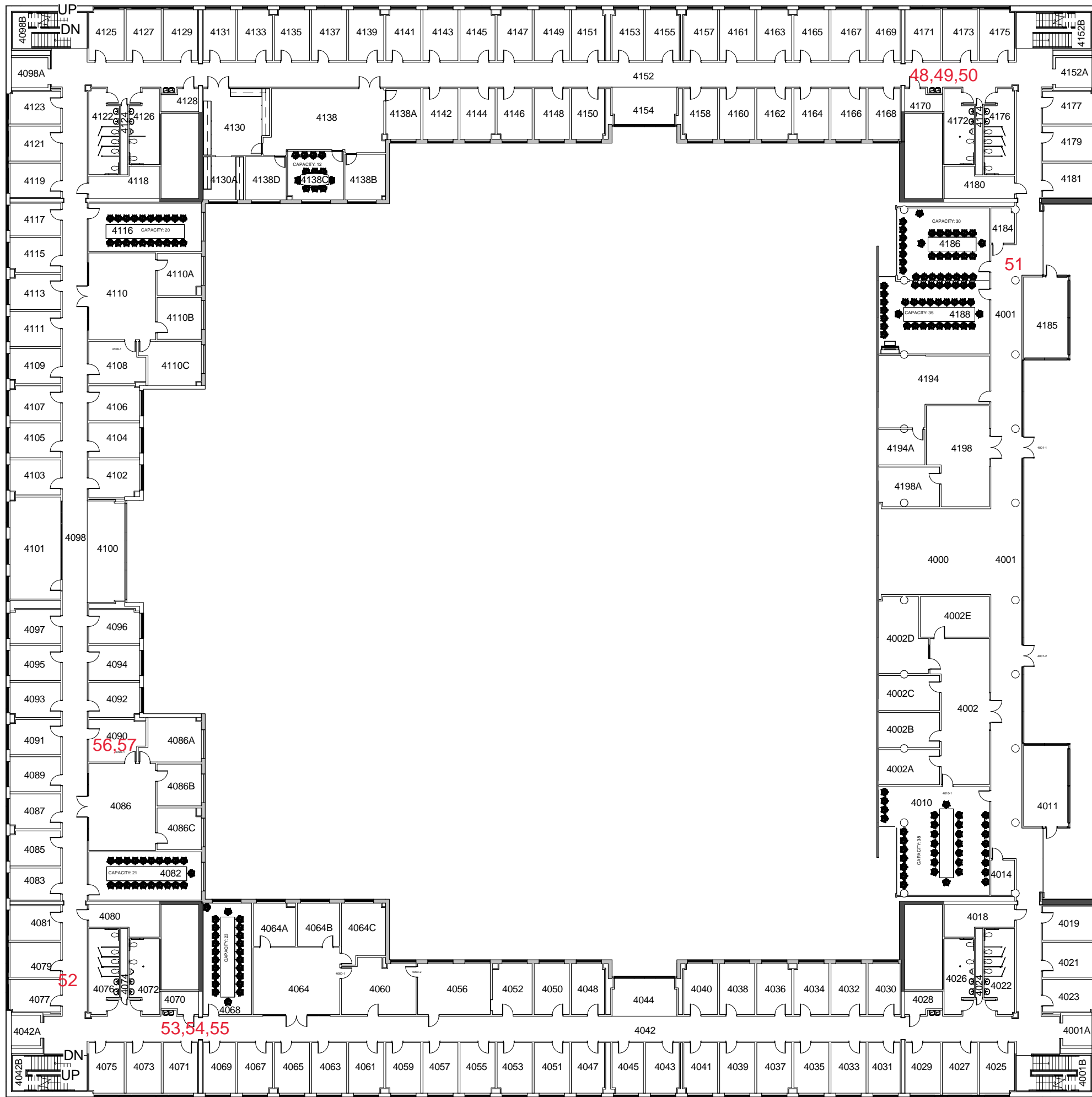

1" = 30'-0"



JFSB
4th Floor

BRIGHAM YOUNG
UNIVERSITY

FACILITIES PLANNING
REVIT DATABASE
8/14/2023
240 BRWB PROVO, UT 84602
PHONE: (801) 422-5504
10:53:17 AM

List of NESHAP Regulated Materials Tested and Found in Surveys

1. Friable asbestos material (>1% asbestos and can be crumbled, pulverized or reduced to powder by hand pressure)

Tested	Materials	Positive
_____	Thermal System Insulation (TSI)	_____
_____	Textured Ceiling Materials (TCM)	_____
_____	Spray-on Insulation or Fireproofing	_____
_____	Blown-in Insulation	_____
_____	Ceiling Tiles/Panels	_____
_____	Plaster, Gypsum Board, Joint Compound	_____
_____	Cloth Materials	_____
_____	Paper Materials	_____
_____	Electrical Wiring Insulation	_____
_____	Sink Undercoating (loose)	_____
_____	Other _____	_____

2. Category I ACM which has become friable

Tested	Materials	Positive
_____	Packings	_____
_____	Gaskets	_____
_____	Vinyl Floor Tile and Sheet Vinyl Flooring	_____
_____	Asphalt Roofing Products	_____

3. Category I ACM that will be or has been subjected to sanding, grinding, cutting or abrading

Tested	Materials	Positive
_____	Packings	_____
_____	Gaskets	_____
_____	Vinyl Floor Tile and Sheet Vinyl Flooring	_____
_____	Asphalt Roofing Products	_____

4. Category II ACM that has a high probability of becoming or has become friable in the course of demolition or renovation operations

Tested	Materials	Positive
_____	Asbestos Cement Materials (transite)	_____
_____	Asphalt, tar and rubber base ACM products other than roofing	_____
_____	Non-asphalt and Non-paper Roofing Products	_____
_____	Paint	_____
_____	Fire Brick and/or Mortar	_____
_____	Stainless Steel Sink Undercoating (solid)	_____
_____	Encapsulated TCM	_____
_____	Encapsulated TSI	_____
_____	Mastic for Floor Tile, Ceiling Tile, Cove Molding, etc.	_____

List of NESHAP Non-Regulated Materials Tested and Found in Survey

1. $\geq 1\%$ Asbestos
2. Category I Non-Friable (cannot be crumbled, pulverized or reduced to powder by hand pressure) ACM with $>1\%$ asbestos by new PLM procedure

Tested	Materials	Positive
_____	Packings	_____
_____	Gaskets	_____
_____	Vinyl Floor Tile and Sheet Vinyl Flooring	_____
_____	Asphalt Roofing Products	_____

3. Category II Non-Friable ACM with $>1\%$ asbestos by new PLM procedure (category includes items meeting Category I definition but not specifically listed in that category)

Tested	Materials	Positive
_____	Asbestos Cement Materials (transite)	_____
_____	Asphalt, tar and rubber base ACM products other than roofing	_____
_____	Non-asphalt and Non-paper Roofing Products	_____
_____	Paint	_____
_____	Fire Brick and/or Mortar	_____
_____	Stainless Steel Sink Undercoating (solid)	_____
_____	Encapsulated TCM	_____
_____	Encapsulated TSI	_____
_____	Mastic for Floor Tile, Ceiling Tile, Cove Molding, etc.	_____
_____	Other _Fume Hood Base_____	_____

Notes

1. All materials and conditions are interpreted by Air Quality Consulting LLC
2. The Environmental Protection Agency (EPA) National Emission Standard for Hazardous Air Pollutants (NESHAP) asbestos revision as outlined in 40 CFR, Part 61, became effective November 20, 1990. The asbestos classification system outlined in the revision and included in this section is dynamic in nature. Asbestos materials classified as “Non-Regulated” at the time of the survey may become “Regulated” due to ongoing or planned maintenance, renovation or demolition actions which can transform a material containing greater than 1% asbestos from a “non-friable” and “Non-Regulated” to a “friable” and “Regulated” condition. Classification of ACM in this section and in the executive summary of this report is, therefore, based on the observations of the surveyor at the time of the survey and may or may not be appropriate at later dates.
3. Maintenance, renovation, demolition, weathering, normal wear, water or other damage can alter the “Non-Regulated” status of materials, and necessitate precautions required for handling them as “Regulated” asbestos-materials.
4. Details on testing locations, methods and results can be found on remaining report.



**Built Environment Testing
Reservoirs**

March 12, 2024

Subcontractor Number:

Laboratory Report: RES 595419-1

Project #/P.O. #: JFSB-3724

Project Description: Joseph F Smith building

Scott Bainbridge
Air Quality Consulting, LLC
226 E 4800 S
Murray UT 84107

Dear Scott,

Eurofins Reservoirs is an analytical laboratory accredited for the analysis of Industrial Hygiene and Environmental matrices by the National Voluntary Laboratory Accreditation Program (NVLAP), Lab Code 101896-0 for Transmission Electron Microscopy (TEM) and Polarized Light Microscopy (PLM) analysis and the American Industrial Hygiene Association (AIHA LAP, LLC), Lab ID 101533 for Phase Contrast Microscopy (PCM) analysis. This laboratory is currently proficient in both Proficiency Testing and PAT programs respectively.

Eurofins Reservoirs has analyzed the following samples for asbestos content as per your request. The analysis has been completed in general accordance with the appropriate methodology as stated in the attached analysis table. The results have been submitted to your office.

RES 595419-1 is the job number assigned to this study. This report is considered highly confidential and the sole property of the customer. Eurofins Reservoirs will not discuss any part of this study with personnel other than those of the client. The results described in this report only apply to the samples analyzed, as received and with the information provided by the customer. This report must not be used to claim endorsement of products or analytical results by NVLAP or any agency of the U.S. Government. This report shall not be reproduced except in full, without written approval from Eurofins Reservoirs. Samples will be disposed of after sixty days unless longer storage is requested. If you have any questions about this report, please feel free to call 303-964-1986.

Sincerely,



by Josh Baker

Jeanne Spencer
President



EUROFINS RESERVOIRS ENVIRONMENTAL, INC

NVLAP Lab Code 101896-0
AIHA LAP, LLC. LAB ID 101533

TABLE: I ANALYSIS: PLM BULK ANALYSIS, PERCENTAGE COMPOSITION BY VOLUME

RES Job Number: **RES 595419-1**
 Client: **Air Quality Consulting, LLC**
 Client Project/P.O.: **JFSB-3724**
 Client Project Description: **Joseph F Smith building**
 Date Samples Received: **March 12, 2024**
 Analysis Type: **EPA 600/R-93/116 - Short Report, Bulk**
 Turnaround: **Rush**
 Date Samples Analyzed: **March 12, 2024**

NA = Not Analyzed
 NR = Not Received
 ND = None Detected
 TR = Trace; <1 % Visual Estimate
 Trem-Act = Tremolite-Actinolite

Laboratory Sample ID	L A Y E R	Physical Description	Sub Part (%)	Asbestos Content		Non-Asbestos Fibrous Components (%)	Non-Fibrous Components (%)
				Mineral	Visual Estimate (%)		
595419 - 1-2x2 Smooth CP	A	Gray/white ceiling tile	100		ND	65	35
595419 - 2-2x2 Smooth Ceiling Panel	A	Gray/white ceiling tile	100		ND	65	35
595419 - 3-2x2 Smooth Ceiling Panel	A	Gray/white ceiling tile	100		ND	65	35
595419 - 4-2x2 Smooth Ceiling Panel	A	Gray/white ceiling tile	100		ND	65	35
595419 - 5-2x2 Smooth Ceiling Panel	A	Gray/white ceiling tile	100		ND	65	35
595419 - 6-TSI	A	Yellow insulation	40		ND	90	10
	B	Off white/silver wrap w/ white paint	60		ND	60	40
595419 - 7-4" Tan cove base and mastic	A	Beige adhesive	25		ND	0	100
	B	Beige cove base	75		ND	0	100
595419 - 8-12x12 Vinyl Tile and Mastic	A	Light gray adhesive	TR		ND	0	100
	B	Tan adhesive	6		ND	0	100
	C	Gray floor tile	94		ND	0	100
595419 - 9-Drywall System	A	White compound w/ off white/white paint	10		ND	0	100
	B	White/tan drywall	90		ND	17	83
595419 - 10-Drywall System	A	White/tan drywall w/ brown multi-layered paint	100		ND	16	84

TEM Analysis recommended for organically bound material (i.e. floor tile) if PLM results are <1%.

EUROFINS RESERVOIRS ENVIRONMENTAL, INC

NVLAP Lab Code 101896-0
AIHA LAP, LLC. LAB ID 101533

TABLE: I ANALYSIS: PLM BULK ANALYSIS, PERCENTAGE COMPOSITION BY VOLUME

RES Job Number: **RES 595419-1**
 Client: **Air Quality Consulting, LLC**
 Client Project/P.O.: **JFSB-3724**
 Client Project Description: **Joseph F Smith building**
 Date Samples Received: **March 12, 2024**
 Analysis Type: **EPA 600/R-93/116 - Short Report, Bulk**
 Turnaround: **Rush**
 Date Samples Analyzed: **March 12, 2024**

NA = Not Analyzed
 NR = Not Received
 ND = None Detected
 TR = Trace; <1 % Visual Estimate
 Trem-Act = Tremolite-Actinolite

Laboratory Sample ID	L A Y E R	Physical Description	Sub Part (%)	Asbestos Content		Non-Asbestos Fibrous Components (%)	Non-Fibrous Components (%)
				Mineral	Visual Estimate (%)		
595419 - 11-Drywall System	A	White compound w/ white paint	6		ND	0	100
	B	White/tan drywall	94		ND	17	83
595419 - 12-Drywall System	A	Tan/white drywall	15		ND	80	20
	B	White compound w/ white paint	85		ND	0	100
595419 - 13-Ceiling Panel	A	Gray/white ceiling tile	100		ND	65	35
595419 - 14-Ceiling Panel	A	Gray/white ceiling tile	100		ND	65	35
595419 - 15-False Floor Concrete	A	Gray cementitious material	100		ND	0	100
595419 - 16-False Floor Concrete	A	Gray cementitious material	100		ND	0	100
595419 - 17-Floor Glue	A	Tan adhesive	100		ND	0	100
595419 - 18-Floor Glue	A	Tan adhesive	100		ND	0	100
595419 - 19-TSI	A	Off white/silver wrap	100		ND	55	45
595419 - 20-Mudded Elbow	A	Yellow insulation w/ white sealant	100		ND	55	45
595419 - 21-Fire Proofing	A	Gray fireproofing	100		ND	10	90
595419 - 22-Fire Proofing	A	Gray fireproofing	100		ND	10	90
595419 - 23-Fire Proofing	A	Gray fireproofing	100		ND	10	90

TEM Analysis recommended for organically bound material (i.e. floor tile) if PLM results are <1%.

EUROFINS RESERVOIRS ENVIRONMENTAL, INC

NVLAP Lab Code 101896-0
AIHA LAP, LLC. LAB ID 101533

TABLE: I ANALYSIS: PLM BULK ANALYSIS, PERCENTAGE COMPOSITION BY VOLUME

RES Job Number: **RES 595419-1**
 Client: **Air Quality Consulting, LLC**
 Client Project/P.O.: **JFSB-3724**
 Client Project Description: **Joseph F Smith building**
 Date Samples Received: **March 12, 2024**
 Analysis Type: **EPA 600/R-93/116 - Short Report, Bulk**
 Turnaround: **Rush**
 Date Samples Analyzed: **March 12, 2024**

NA = Not Analyzed
 NR = Not Received
 ND = None Detected
 TR = Trace; <1 % Visual Estimate
 Trem-Act = Tremolite-Actinolite

Laboratory Sample ID	L A Y E R	Physical Description	Sub Part	Asbestos Content		Non-Asbestos Fibrous Components (%)	Non-Fibrous Components (%)
				Mineral	Visual Estimate (%)		
Client Sample Number			(%)		(%)		
595419 - 24-Mudded Elbow	A	Gray insulation w/ white sealant	100		ND	55	45
595419 - 25-Fire Proofing	A	Gray fireproofing	100		ND	10	90
595419 - 26-Fire Proofing	A	Gray fireproofing	100		ND	10	90
595419 - 27-12x12 Vinyl Tile and Mastic	A	Off white/tan adhesive	10		ND	0	100
	B	Gray/dark gray speckled flooring	90		ND	0	100
595419 - 28-12x12 Vinyl Tile and Mastic	A	Off white/tan adhesive	8		ND	0	100
	B	Gray/dark gray speckled flooring	92		ND	0	100
595419 - 29-TSI	A	Light yellow insulation w/ white sealant	100		ND	75	25
595419 - 30-12x12 Vinyl Tile and Mastic	A	Off white floor tile	100		ND	0	100
595419 - 31-4" Tan cove base and mastic	A	Colorless adhesive	2		ND	0	100
	B	Tan cove base	98		ND	0	100
595419 - 32-Worm Hole Ceiling Panel	A	Gray/white ceiling tile	100		ND	65	35
595419 - 33-Worm Hole Ceiling Panel	A	White compound w/ white paint	25		ND	0	100
	B	Tan/white drywall	75		ND	60	40
595419 - 34-Drywall System	A	Gray/white ceiling tile	100		ND	65	35

TEM Analysis recommended for organically bound material (i.e. floor tile) if PLM results are <1%.

EUROFINS RESERVOIRS ENVIRONMENTAL, INC

NVLAP Lab Code 101896-0
AIHA LAP, LLC. LAB ID 101533

TABLE: I ANALYSIS: PLM BULK ANALYSIS, PERCENTAGE COMPOSITION BY VOLUME

RES Job Number: **RES 595419-1**
 Client: **Air Quality Consulting, LLC**
 Client Project/P.O.: **JFSB-3724**
 Client Project Description: **Joseph F Smith building**
 Date Samples Received: **March 12, 2024**
 Analysis Type: **EPA 600/R-93/116 - Short Report, Bulk**
 Turnaround: **Rush**
 Date Samples Analyzed: **March 12, 2024**

NA = Not Analyzed
 NR = Not Received
 ND = None Detected
 TR = Trace; <1 % Visual Estimate
 Trem-Act = Tremolite-Actinolite

Laboratory Sample ID	L A Y E R	Physical Description	Sub Part	Asbestos Content		Non-Asbestos Fibrous Components (%)	Non-Fibrous Components (%)
				Mineral	Visual Estimate (%)		
Client Sample Number			(%)		(%)		
595419 - 35-12x12 Vinyl Tile and Mastic	A	Tan adhesive	2		ND	0	100
	B	Off white floor tile	98		ND	0	100
595419 - 36-4" Tan cove base and mastic	A	Beige adhesive	6		ND	0	100
	B	Tan cove base	94		ND	0	100
595419 - 37-Drywall System	A	White/tan drywall w/ white paint	100		ND	15	85
595419 - 38-Drywall System	A	White compound w/ gray/white paint	7		ND	0	100
	B	White/tan drywall	93		ND	17	83
595419 - 39-Drywall System	A	Gray/white paint w/ white compound	4		ND	0	100
	B	White/tan drywall	96		ND	17	83
595419 - 40-Drywall System	A	White/tan drywall w/ off white paint	100		ND	15	85
595419 - 41-4" Tan cove base and mastic	A	Beige adhesive	9		ND	0	100
	B	Tan cove base	91		ND	0	100
595419 - 42-12x12 Vinyl Tile and Mastic	A	Tan adhesive	3		ND	0	100
	B	Off white floor tile	97		ND	0	100

TEM Analysis recommended for organically bound material (i.e. floor tile) if PLM results are <1%.

EUROFINS RESERVOIRS ENVIRONMENTAL, INC

NVLAP Lab Code 101896-0
AIHA LAP, LLC. LAB ID 101533

TABLE: I ANALYSIS: PLM BULK ANALYSIS, PERCENTAGE COMPOSITION BY VOLUME

RES Job Number: **RES 595419-1**
 Client: **Air Quality Consulting, LLC**
 Client Project/P.O.: **JFSB-3724**
 Client Project Description: **Joseph F Smith building**
 Date Samples Received: **March 12, 2024**
 Analysis Type: **EPA 600/R-93/116 - Short Report, Bulk**
 Turnaround: **Rush**
 Date Samples Analyzed: **March 12, 2024**

NA = Not Analyzed
 NR = Not Received
 ND = None Detected
 TR = Trace; <1 % Visual Estimate
 Trem-Act = Tremolite-Actinolite

Laboratory Sample ID	L A Y E R	Physical Description	Sub Part	Asbestos Content		Non-Asbestos Fibrous Components (%)	Non-Fibrous Components (%)
				Mineral	Visual Estimate (%)		
Client Sample Number			(%)		(%)		
595419 - 43-Drywall System	A	White compound w/ gray/white paint	6		ND	0	100
	B	White/tan drywall	94		ND	17	83
595419 - 44-12x12 Vinyl Tile and Mastic	A	Tan adhesive	TR		ND	0	100
	B	Off white floor tile	100		ND	0	100
595419 - 45-4" Tan cove base and mastic	A	Beige adhesive	1		ND	0	100
	B	Tan cove base	99		ND	0	100
595419 - 46-Worm Hole Ceiling Panel	A	Gray/white ceiling tile	100		ND	65	35
595419 - 47-Worm Hole Ceiling Panel	A	Gray/white ceiling tile	100		ND	65	35
595419 - 48-Drywall	A	White compound w/ white paint	13		ND	0	100
	B	White/tan drywall	87		ND	35	65
595419 - 49-12x12 Vinyl Tile and Mastic	A	Tan adhesive	TR		ND	0	100
	B	Off white floor tile	100		ND	0	100
595419 - 50-4" Tan cove base and mastic	A	Beige adhesive	4		ND	0	100
	B	Tan cove base	96		ND	0	100
595419 - 51-Worm Hole Ceiling Panel	A	Gray ceiling tile	100		ND	65	35

TEM Analysis recommended for organically bound material (i.e. floor tile) if PLM results are <1%.

EUROFINS RESERVOIRS ENVIRONMENTAL, INC

NVLAP Lab Code 101896-0
AIHA LAP, LLC. LAB ID 101533

TABLE: I ANALYSIS: PLM BULK ANALYSIS, PERCENTAGE COMPOSITION BY VOLUME

RES Job Number: **RES 595419-1**
 Client: **Air Quality Consulting, LLC**
 Client Project/P.O.: **JFSB-3724**
 Client Project Description: **Joseph F Smith building**
 Date Samples Received: **March 12, 2024**
 Analysis Type: **EPA 600/R-93/116 - Short Report, Bulk**
 Turnaround: **Rush**
 Date Samples Analyzed: **March 12, 2024**

NA = Not Analyzed
 NR = Not Received
 ND = None Detected
 TR = Trace; <1 % Visual Estimate
 Trem-Act = Tremolite-Actinolite

Laboratory Sample ID Client Sample Number	L A Y E R	Physical Description	Sub Part (%)	Asbestos Content		Non-Asbestos Fibrous Components (%)	Non-Fibrous Components (%)
				Mineral	Visual Estimate (%)		
595419 - 52-Worm Hole Ceiling Panel	A	Gray/white ceiling tile	100		ND	65	35
595419 - 53-Drywall	A	White compound w/ gray paint	7		ND	0	100
	B	White compound w/ white paint	11		ND	0	100
	C	White/tan drywall	82		ND	25	75
595419 - 54-12x12 Vinyl Tile and Mastic	A	Tan adhesive	TR		ND	0	100
	B	Off white floor tile	100		ND	0	100
595419 - 55-4" Tan cove base and mastic	A	Beige adhesive	9		ND	0	100
	B	Tan cove base	91		ND	0	100
595419 - 56-Drywall	A	White compound w/ gray/white paint	7		ND	0	100
	B	Off white/tan drywall	93		ND	25	75
595419 - 57-Drywall	A	Off white/tan drywall w/ gray/white paint	100		ND	16	84

TEM Analysis recommended for organically bound material (i.e. floor tile) if PLM results are <1%.



Josh Baker
Analyst

SUBMITTED BY	INVOICE TO	CONTACT INFORMATION	SERIES
Company: Air Quality Consulting, LLC	Company: Air Quality Consulting, LLC	Contact: Scott Bainbridge	-1 PLM Rush *NO VERBALS*
Address: 226 E 4800 S	Address: 226 E 4800 S	Phone: (385) 321-9701	
Murray, UT 84107	Murray, UT 84107	Fax:	
Project Number and/or P.O. #: JFSB-3724		Cell: (385) 321-9701	
Project Description/Location: Joseph F Smith building		Final Data Deliverable Email Address: scott@airqualityconsult.com (+ 2 ADDNL. CONTACTS)	

ASBESTOS LABORATORY HOURS: Weekdays: 7am - 7pm & Sat. 8am - 5pm		REQUESTED ANALYSIS				VALID MATRIX CODES		LAB NOTES
PLM / PCM / TEM	DTL RUSH PRIORITY STANDARD	PLM - PLM Short Report (EPA/600/R-93/116) TEM - AHERA (+/- or Quantified), Microvacc (+/- or Quantified), Wipe (+/- or Quantified), NIOSH 7402, Yamate Level III, ISO 10312, ISO 13794, Chatfield, Drinking Water, Waste Water, Bulk +/-, C/BB, Modified Ahera PCM - 7400A, 7400B, OSHA DUST - Total, Respirable METALS - Analyte(s) Lead Only (7082, 7420, Waste Water, Foodware, Multi Metals (7303, 6020A, 200.8, Waste Water, Foodware, OSHA ID-125G), pH (Liquid or Non-Liquid), TCLP, RCRA, & Scan, Wetting, Fume Scan, Full Metals Scan ORGANICS - Methamphetamine, TSS VIABLES - Campylobacter, Bacillus, Salmonella (Culturable or 1-2), Listeria, E.coli O157:H7, E.coli Coliforms - Plated, S.aureus, Yeast & Mol, Aerobic Plate Count, Coliforms/E.coli - (State Water, Drinking Water, Non-Drinking Water, +/-, Quantification), Lactic Acid, Viable Microbial Count (w/o ID or w/ID), Enterococcus (+/- or Quantification), Legionella (P, NP, C) MEDICAL - Biorburden, LAL MOLD - Spore Trap, Bulk Mold, Particulate Identification	Air = A	Bulk = B	Laboratory Analysis Instructions			
CHEMISTRY LABORATORY HOURS: Weekdays: 8am - 5pm	Dust RUSH PRIORITY STANDARD		Dust = D	Food = F				
Metals	RUSH PRIORITY STANDARD		Paint = P	Soil = S				
Organics*	SAME DAY RUSH PRIORITY STANDARD		Surface = SU	Swab = SW				
MICROBIOLOGY LABORATORY HOURS: Weekdays: 8am - 5pm	PRIOR NOTICE REQUIRED FOR SAME DAY TAT		Tape = T	Wipe = W				
Viability Analysis**	PRIORITY STANDARD		Drinking Water = DW					
Medical Device Analysis	RUSH STANDARD		Waste Water = WW					
Mold Analysis	RUSH PRIORITY STANDARD		**ASTM E1792 approved wipe media only**					
Turnaround times establish a laboratory priority, subject to laboratory volume and are not guaranteed. Additional fees apply for afterhours, weekends and holidays.			Sample Volume (L) / Area	Length (or Aliquots) x Width (or Area per Aliquot)				
Special Instructions:			Matrix Code	# of Containers				
Client Sample ID Number (Sample ID's must be unique)			Date Collected mm/dd/yy	Time Collected hh:mm				
ASBESTOS	CHEMISTRY		MICROBIOLOGY	ICO				
1 1-2x2 Smooth CP	X							
2 2-2x2 Smooth Ceiling Panel	X							
3 3-2x2 Smooth Ceiling Panel	X							
4 4-2x2 Smooth Ceiling Panel	X							
5 5-2x2 Smooth Ceiling Panel	X							
6 6-TSI	X							
7 7-4" Tan cove base and mastic	X							
8 8-12x12 Vinyl Tile and Mastic	X							
9 9-Drywall System	X							
10 10-Drywall System	X							
11 11-Drywall System	X							
12 12-Drywall System	X							
13 13-Ceiling Panel	X							

EREI establishes a unique Lab Sample ID, for each sample, by preceding each unique Client Sample ID with the laboratory RES Job Number.

EREI will analyze incoming samples based on information received and will not be responsible for errors or omissions in calculations resulting from the inaccuracy of original data. By signing, client/company representative agrees that submission of the following samples for requested analysis as indicated on this Chain of Custody shall constitute an analytical services agreement with payment terms of NET 30 days. Failure to comply with payment terms may result in a 1.5% monthly interest surcharge.

Relinquished By:	Scott Bainbridge	Date/Time: 03/12/2024 14:27:41	Sample Condition: Acceptable
Received By:	Jessica Parker	Date/Time: 03/12/2024 14:34:10	Carrier: Fed-Ex



Built Environment Testing Reservoirs

RES Job #: 595419

Submitted By: Air Quality Consulting, LLC

Client Sample ID Number <small>(Sample ID's must be unique)</small>	REQUESTED ANALYSIS					VALID MATRIX CODES					LAB NOTES								
	ASBESTOS	CHEMISTRY	MICROBIOLOGY	ICO		Air = A	Bulk = B	Dust = D	Food = F	Paint = P	Soil = S	Surface = SU	Swab = SW	Tape = T	Wipe = W	Drinking Water = DW	Waste Water = WW	**ASTM E1792 approved wipe media only**	Laboratory Analysis Instructions
						Sample Volume (L) / Area	Length (or Aliquots) x Width (or Area) per Aliquot	Matrix Code	# of Containers	Date Collected mm/dd/yy	Time Collected hh:mm								
14 14-Ceiling Panel	X							B											
15 15-False Floor Concrete	X							B											
16 16-False Floor Concrete	X							B											
17 17-Floor Glue	X							B											
18 18-Floor Glue	X							B											
19 19-TSI	X							B											
20 20-Mudded Elbow	X							B											
21 21-Fire Proofing	X							B											
22 22-Fire Proofing	X							B											
23 23-Fire Proofing	X							B											
24 24-Mudded Elbow	X							B											
25 25-Fire Proofing	X							B											
26 26-Fire Proofing	X							B											
27 27-12x12 Vinyl Tile and Mastic	X							B											
28 28-12x12 Vinyl Tile and Mastic	X							B											
29 29-TSI	X							B											
30 30-12x12 Vinyl Tile and Mastic	X							B											
31 31-4" Tan cove base and mastic	X							B											
32 32-Worm Hole Ceiling Panel	X							B											
33 33-Worm Hole Ceiling Panel	X							B											
34 34-Drywall System	X							B											
35 35-12x12 Vinyl Tile and Mastic	X							B											
36 36-4" Tan cove base and mastic	X							B											
37 37-Drywall System	X							B											
38 38-Drywall System	X							B											
39 39-Drywall System	X							B											
40 40-Drywall System	X							B											
41 41-4" Tan cove base and mastic	X							B											
42 42-12x12 Vinyl Tile and Mastic	X							B											
43 43-Drywall System	X							B											



Built Environment Testing Reservoirs

RES Job #: **595419**

Submitted By: **Air Quality Consulting, LLC**

Client Sample ID Number <small>(Sample ID's must be unique)</small>	REQUESTED ANALYSIS				VALID MATRIX CODES					LAB NOTES	
	ASBESTOS	CHEMISTRY	MICROBIOLOGY	ICO	Air = A	Bulk = B	Dust = D	Food = F	Paint = P	Soil = S	Laboratory Analysis Instructions
44 44-12x12 Vinyl Tile and Mastic	X										
45 45-4" Tan cove base and mastic	X										
46 46-Worm Hole Ceiling Panel	X										
47 47-Worm Hole Ceiling Panel	X										
48 48-Drywall	X										
49 49-12x12 Vinyl Tile and Mastic	X										
50 50-4" Tan cove base and mastic	X										
51 51-Worm Hole Ceiling Panel	X										
52 52-Worm Hole Ceiling Panel	X										
53 53-Drywall	X										
54 54-12x12 Vinyl Tile and Mastic	X										
55 55-4" Tan cove base and mastic	X										
56 56-Drywall	X										
57 57-Drywall	X										

PLM - PLM Short Report (EPA/600/R-93/116)
TEM - AHERA (+/- or Quantified), Microvac (+/- or Quantified), Wipe (+/- or Quantified), NIOSH 7402, Yamate Level II, ISO 10312, ISO 13794, Chatfield, Drinking Water, Waste Water, Bulk +/-, CARB Modified Ahera
PCM - 7400A, 7400B, OSHA
DUST - Total, Respirable
METALS - Analyte(s)
 Lead Only (7082, 7420, Waste Water, Foodware), Multi Metals (7303, 6020A, 200.8, Waste Water, Foodware, OSHA ID-125G), pH (Liquid or Non-Liquid), TCLP, RCRA 8 Scan, Welding Fume Scan, Full Metals Scan
ORGANICS - Methamphetamine, TSS
VABLES - Campylobacter, Bacillus, Salmonella (Culturable or 1-2), Listeria, E.coli O157:H7, E.coli/Coliforms - Plated, S aureus, Yeast & Mol, Aerobic Plate Count, Coliforms/E.coli - (State Water, Drinking Water, Non-Drinking Water +/-, Quantification), Lactic Acid, Viable Microbial Count (wo/ID or w/ID), Enterococcus (+/- or Quantification), Legionella (P, NP, C)
MEDICAL - Bioburden, LAL
MOLD - Spore Trap, Bulk Mold, Particulate Identification

VALID MATRIX CODES
 Air = A Bulk = B
 Dust = D Food = F
 Paint = P Soil = S
 Surface = SU Swab = SW
 Tape = T Wipe = W
 Drinking Water = DW
 Waste Water = WW
****ASTM E1792 approved wipe media only****

LABORATORY ANALYSIS INSTRUCTIONS
 Sample Volume (L) / Area
 Length (or Aliquots) x Width (or Area per Aliquot)
 Matrix Code
 # of Containers
 Date Collected mm/dd/yy
 Time Collected hh:mm



**Built Environment Testing
Reservoirs**

REMIT TO: Eurofins Reservoirs Environmental, Inc, PO BOX 3067, Carol Stream, IL 60132-3067

<p>Invoice To:</p> <p>Air Quality Consulting, LLC 226 E 4800 S Murray UT 84107</p>	<p>Invoice Date: March 12, 2024 Invoice Number: 166297</p> <p>TERMS: Net 30 Days</p> <p>Service Charge of 18% per annum may be charged on past due invoices.</p>
---	---

Quantity	Analytical Procedure	Unit Price	Amount
57	<p>RES Job#: RES 595419-1 Submitted By: Air Quality Consulting, LLC P/O Number: JFSB-3724 Description: Joseph F Smith building Contact: Scott Bainbridge</p> <p>PLM Short Report (EPA/600 /R-93/116) Bulk Rush</p>	\$19.00	\$1,083.00
Invoice Total:			\$1,083.00

Our FID# 22-3874111

BANKING INFORMATION

Payment Options

1. **ACH (Automated Clearing House):**

Please remit the funds to:

Citibank
One Penns Way
New Castle, DE 19720
Beneficiary: **Eurofins Reservoirs Environmental, Inc**
Account Number: **54101317**
Routing/ABA Number: **031100209**
Swift Number: CITIUS33

Please email remittance documentation to AR@eurofinsus.com

2. **Wire:**

Please remit the funds to:

Citibank
One Penns Way
New Castle, DE 19720
Beneficiary: **Eurofins Reservoirs Environmental, Inc**
Account Number: **54101317**
Routing/ABA Number: **031100209**
Swift Number: CITIUS33

Please email remittance documentation to AR@eurofinsus.com

3. **Check** - Remit check to the bank lockbox:

Please include details of payment on the check stub including the invoice number and amount paid.

Lockbox Address:

Eurofins Reservoirs Environmental, Inc
PO BOX 3067
Carol Stream, IL 60132-3067

Overnight Address: (FedEx, UPS, etc)

Remitco
Attn: Eurofins Reservoirs Environmental, Inc
PO BOX 3067
5450 N. Cumberland Ave, Chicago, IL, 60656

4. **Credit Card** - Pay using a credit card:

Payments can now be made using a credit card by logging onto the ADMIN portion of the Online Client Portal and under the "Invoices" section.

or

By contacting Lynn Klover with your request via email at Lynn.Klover@ET.eurofinsUS.com or by phone: 720-387-0444

Eurofins Reservoirs Environmental, Inc

Accounts Receivable

343 W. Main Street, Leola, PA 17540

Phone: (717) 656-2300

AR@eurofinsus.com • www.EurofinsUS.com

**Asbestos Survey and Assessment Performed at
Joseph F. Smith Building
1100 Campus Drive
Provo, Utah, 84604
March 12, 2024**

Scope of Work

We were hired by BYU to survey the JFS Building for a pending renovation. Samples were taken by Scott Bainbridge and Anabelle Mitchell on March 11, 2024 and tested at Reservoirs Environmental in Denver, Colorado. The results are included in this report.

Methods and Materials

A survey of the areas outlined in the floorplan sections was conducted to observe, identify, locate and sample any materials suspected of containing asbestos according to NESHAP categories. All accessible areas were identified and documented.

Bulk samples were collected using approved methods and microscopically analyzed for asbestos content by Reservoirs Environmental, Inc. in Denver, Colorado. Reservoirs participates in the National Institute for Standards and Technology's National Voluntary Laboratory Accreditation Program (NVLAP).

Asbestos percentages were estimated utilizing the polarized light microscope (PLM) and dispersion staining methods as prescribed by NIOSH.

Scott Bainbridge

Scott Bainbridge
State of Utah Inspector #ASB-6822 exp. 10/19/24

March 12, 2024

Date

Annabelle Mitchell

Annabelle Mitchell
State of Utah Inspector #ASB-8012 exp. 12/15/24

March 12, 2024

Date

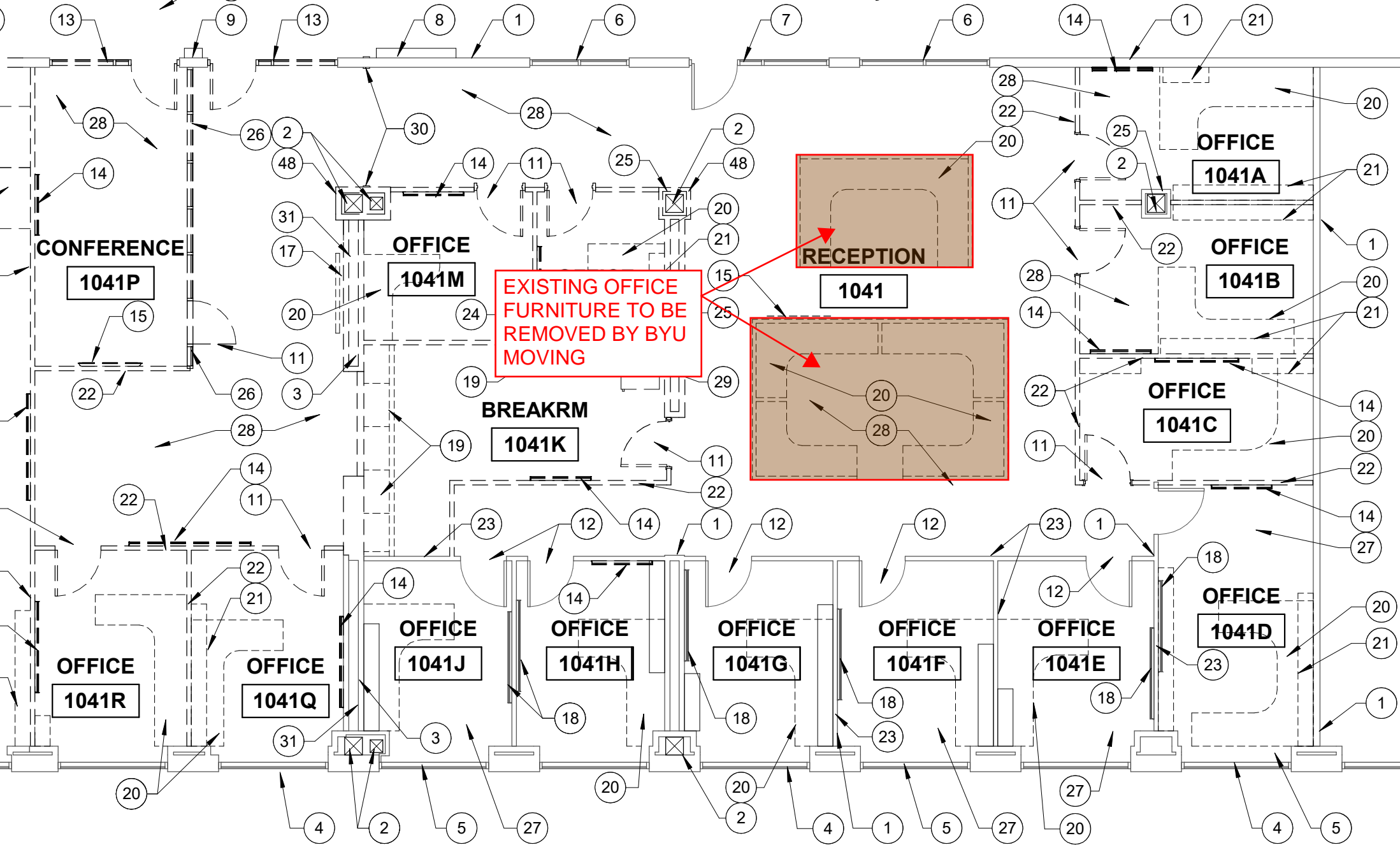

BRIGHAM YOUNG UNIVERSITY

ADDENDUM RECEIPT

DATE: March 14, 2024

PROJECT: JFSB 2024 CNA Remodel Office Suites 1041 & 1053

PROJ. #: W.O. K8101 & N4027

We acknowledge receipt of Addendum Number 2.

COMPANY: _____

BY: _____

TITLE: _____

PLEASE EMAIL SIGNED RECEIPT TO construction@byu.edu