



Salt Lake City School District

Backman Elementary School

Signage

601 N 1500 W
Salt Lake City, Utah 84116

Construction Documents



DESIGN TEAM

ARCHITECT
NJRA Architects, Inc.
5223 South Ascension Way, Suite 350
Murray, Utah 84123
Phone: 801.364.9259

Contacts:
Project Manager: Melissa Allen
Email: melali@njraarchitects.com



NJRA Architects, Inc.
5223 S. Ascension Way, Suite 350
Murray, Utah 84123
801.364.9259
www.njraarchitects.com

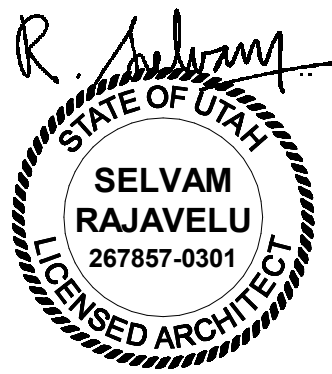

Salt Lake City School District
Backman Elementary School
Signage

601 N 1500 W
Salt Lake City, Utah 84116

NJRA Project # 24726.00
Construction Documents Feb 14, 2025

Cover Sheet

G001

GENERAL NOTES

- A. REMOVE ALL EXISTING WALL-MOUNTED PANEL SIGNS IN THE BUILDING (NOT SHOWN ON THESE PLANS). VERIFY EXISTING SIGN LOCATIONS AND QUANTITIES IN THE FIELD PRIOR TO PREPARING BIDS.
- B. VERIFY BUILDING CONDITIONS IN THE FIELD. IF THERE IS A CONFLICT WITH SIGN TYPE OR SIGN LOCATION AS SHOWN IN THESE PLANS, COORDINATE WITH THE ARCHITECT AND OWNER'S REPRESENTATIVE FOR AN ALTERNATE SOLUTION.
- C. SEE SIGN TYPE DETAIL (DETAIL 1/A506A) FOR ALL TYPICAL SIGN TYPES (S1-S6).
- D. SEE SIGN MOUNTING DETAIL (DETAIL 2/A506A) FOR LOCATION OF SIGN IN RELATION TO DOOR OR OPENING. COMPLY WITH ADA FOR ALL MOUNTING LOCATIONS. IF SIGN OCCURS ON A WINDOW OR DOOR SIDELIGHT, MOUNT WITH ADHESIVE AND PROVIDE BACK-UP SHAPE ON OPPOSITE SIDE OF GLASS. IF SIGN LOCATION SHOWN CONFLICTS WITH A BUILDING ELEMENT, COORDINATE WITH THE ARCHITECT AND OWNER'S REPRESENTATIVE FOR AN ALTERNATE LOCATION.
- E. EXISTING SIGN IN SOME AREAS ARE MOUNTED ON GYPSUM BOARD AND MASONRY WALLS WITH FASTENERS (SCREWS, METAL INSERTS, PLASTIC INSERTS, TOGGLE BOLTS, ETC.). WHERE EXISTING SIGNS ARE BEING REPLACED WITH NEW SIGNS, REMOVE ALL EXISTING FASTENERS AND PATCH HOLES ON GYPSUM BOARD WALLS AND MASONRY WALLS AS REQUIRED. IN MOST PLACES, NEW SIGNS SHALL COVER THE PATCHED HOLES AND PAINTING IS NOT REQUIRED. IF NEW SIGNS ARE NOT COVERING THE WALL PATCH, WALLS SHALL BE PAINTED TO COVER THE PATCH. THE PAINT COLOR SHALL MATCH EXISTING WALL COLOR. IT IS NOT REQUIRED TO PAINT THE ENTIRE WALL. PAINT ONLY A 2" BORDER AROUND THE SIGN. SEE PAINT SCHEDULE DETAIL 3 ON SHEET A506A.

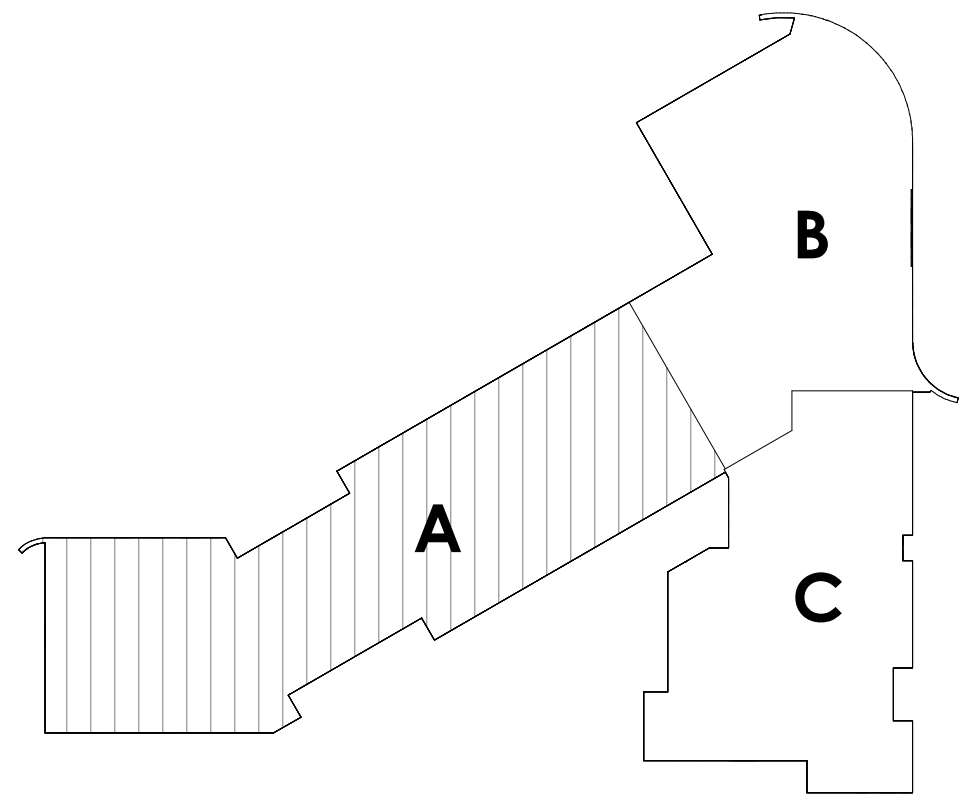

Key Plan - Area A

SCALE: 1" = 80'-0"

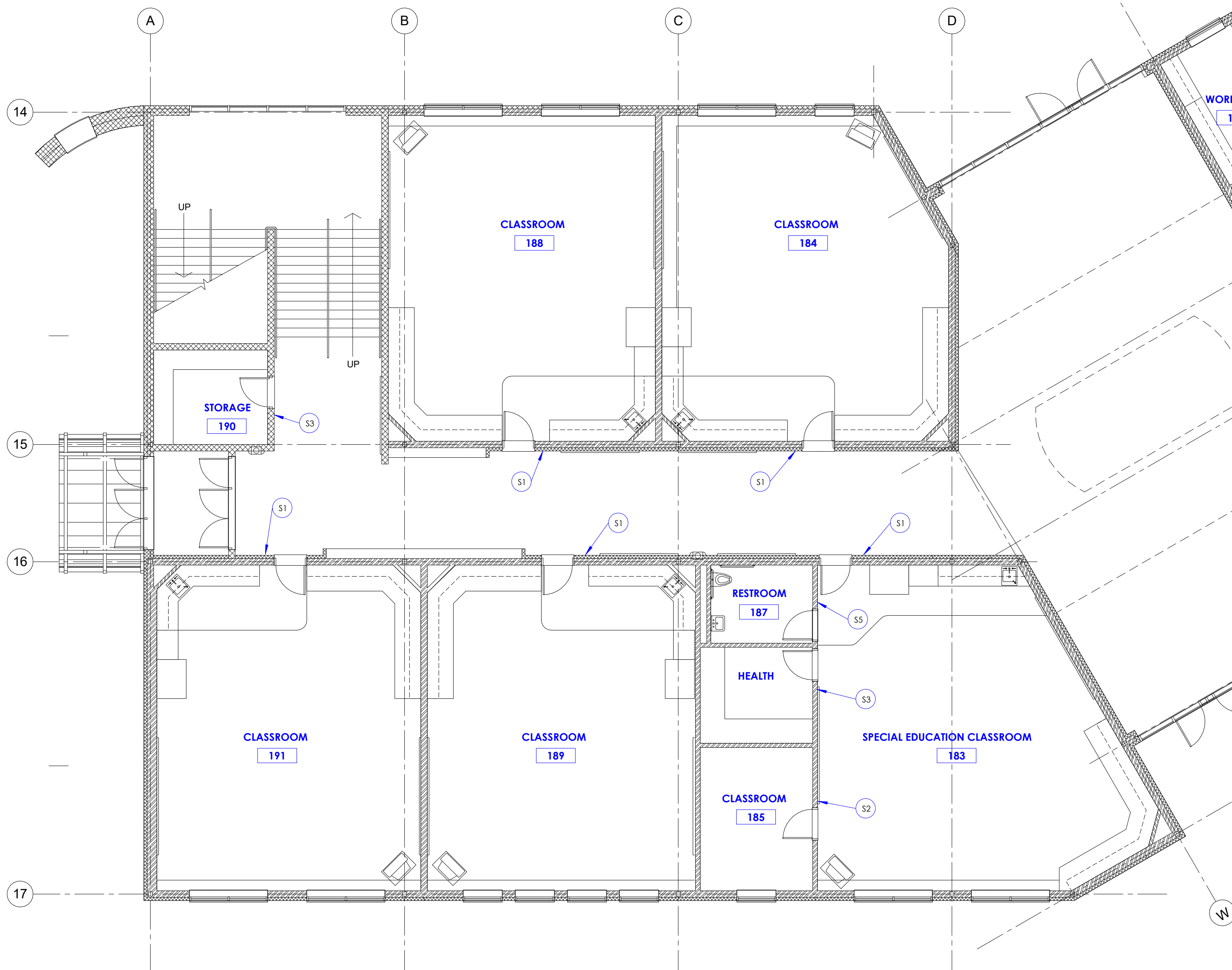

Salt Lake City School District
Backman Elementary School
Signage

NJRA Project # 24726.00
Construction Documents Feb 14, 2025

Floor Plan
Level 1 - Area
A

A110A

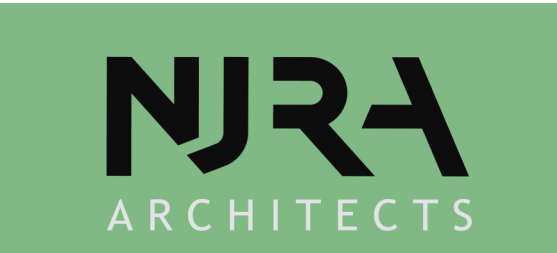

NJRA Architects, Inc.
5223 S. Ascension Way, Suite 350
Murray, Utah 84123
801.364.9259
www.njraarchitects.com

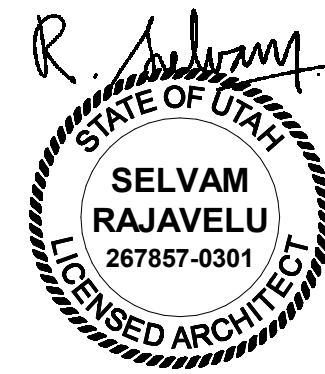

GENERAL NOTES

- A. REMOVE ALL EXISTING WALL-MOUNTED PANEL SIGNS IN THE BUILDING (NOT SHOWN ON THESE PLANS). VERIFY EXISTING SIGN LOCATIONS AND QUANTITIES IN THE FIELD PRIOR TO PREPARING BIDS.
- B. VERIFY BUILDING CONDITIONS IN THE FIELD. IF THERE IS A CONFLICT WITH SIGN TYPE OR SIGN LOCATION AS SHOWN IN THESE PLANS, COORDINATE WITH THE ARCHITECT AND OWNER'S REPRESENTATIVE FOR AN ALTERNATE SOLUTION.
- C. SEE SIGN TYPE DETAIL (DETAIL 1/A506A) FOR ALL TYPICAL SIGN TYPES (S1-S6).
- D. SEE SIGN MOUNTING DETAIL (DETAIL 2/A506A) FOR LOCATION OF SIGN IN RELATION TO DOOR OR OPENING. COMPLY WITH ADA FOR ALL MOUNTING LOCATIONS. IF SIGN OCCURS ON A WINDOW OR DOOR SIDELIGHT, MOUNT WITH ADHESIVE AND PROVIDE BACK-UP SHAPE ON OPPOSITE SIDE OF GLASS. IF SIGN LOCATION SHOWN CONFLICTS WITH A BUILDING ELEMENT, COORDINATE WITH THE ARCHITECT AND OWNER'S REPRESENTATIVE FOR AN ALTERNATE LOCATION.
- E. EXISTING SIGN IN SOME AREAS ARE MOUNTED ON GYPSUM BOARD AND MASONRY WALLS WITH FASTENERS (SCREWS, METAL INSERTS, PLASTIC INSERTS, TOGGLE BOLTS, ETC.). WHERE EXISTING SIGNS ARE BEING REPLACED WITH NEW SIGNS, REMOVE ALL EXISTING FASTENERS AND PATCH HOLES ON GYPSUM BOARD WALLS AND MASONRY WALLS AS REQUIRED. IN MOST PLACES, NEW SIGNS SHALL COVER THE PATCHED HOLES AND PAINTING IS NOT REQUIRED. IF NEW SIGNS ARE NOT COVERING THE WALL PATCH, WALLS SHALL BE PAINTED TO COVER THE PATCH. THE PAINT COLOR SHALL MATCH EXISTING WALL COLOR. IT IS NOT REQUIRED TO PAINT THE ENTIRE WALL. PAINT ONLY A 2" BORDER AROUND THE SIGN. SEE PAINT SCHEDULE DETAIL 3 ON SHEET A506A.

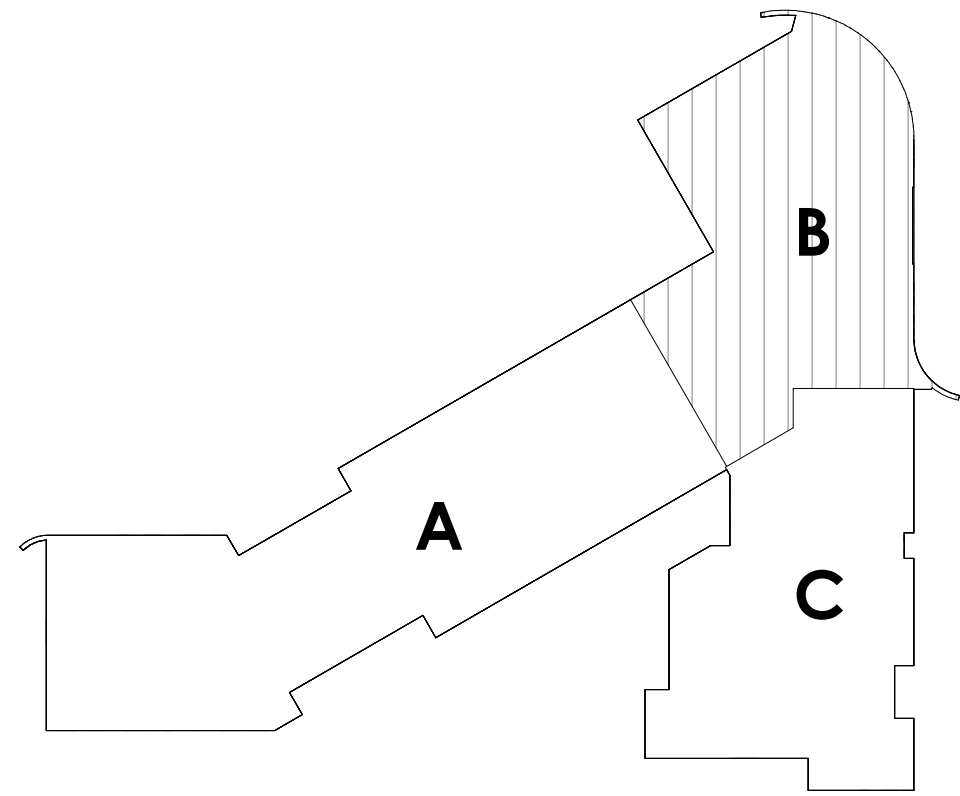

Key Plan - Area B

SCALE: 1" = 80'-0"



1

Floor Plan Level 1 Area B

SCALE: 1/8" = 1'-0"



NJRA Architects, Inc.
5223 S. Ascension Way, Suite 350
Murray, Utah 84123
801.364.9259
www.njraarchitects.com

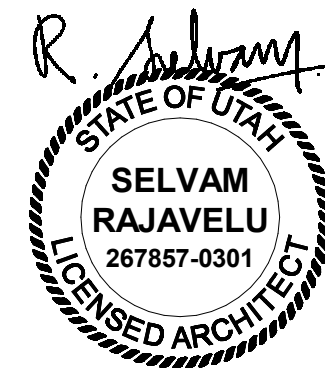

Salt Lake City School District
Backman Elementary School
Signage

601 N 1500 W
Salt Lake City, Utah 84116

NJRA Project # 24726.00
Construction Documents Feb 14, 2025

Floor Plan
Level 1 - Area
B

A110B

- GENERAL NOTES**
- A. REMOVE ALL EXISTING WALL-MOUNTED PANEL SIGNS IN THE BUILDING (NOT SHOWN ON THESE PLANS). VERIFY EXISTING SIGN LOCATIONS AND QUANTITIES IN THE FIELD PRIOR TO PREPARING BIDS.
- B. VERIFY BUILDING CONDITIONS IN THE FIELD. IF THERE IS A CONFLICT WITH SIGN TYPE OR SIGN LOCATION AS SHOWN IN THESE PLANS, COORDINATE WITH THE ARCHITECT AND OWNER'S REPRESENTATIVE FOR AN ALTERNATE SOLUTION.
- C. SEE SIGN TYPE DETAIL (DETAIL 1/A506A) FOR ALL TYPICAL SIGN TYPES (S1-S6).
- D. SEE SIGN MOUNTING DETAIL (DETAIL 2/A506A) FOR LOCATION OF SIGN IN RELATION TO DOOR OR OPENING. COMPLY WITH ADA FOR ALL MOUNTING LOCATIONS. IF SIGN OCCURS ON A WINDOW OR DOOR SIDELIGHT, MOUNT WITH ADHESIVE AND PROVIDE BACK-UP SHAPE ON OPPOSITE SIDE OF GLASS. IF SIGN LOCATION SHOWN CONFLICTS WITH A BUILDING ELEMENT, COORDINATE WITH THE ARCHITECT AND OWNER'S REPRESENTATIVE FOR AN ALTERNATE LOCATION.
- E. EXISTING SIGN IN SOME AREAS ARE MOUNTED ON GYPSUM BOARD AND MASONRY WALLS WITH FASTENERS (SCREWS, METAL INSERTS, PLASTIC INSERTS, TOGGLE BOLTS, ETC.). WHERE EXISTING SIGNS ARE BEING REPLACED WITH NEW SIGNS, REMOVE ALL EXISTING FASTENERS AND PATCH HOLES ON GYPSUM BOARD WALLS AND MASONRY WALLS AS REQUIRED. IN MOST PLACES, NEW SIGNS SHALL COVER THE PATCHED HOLES AND PAINTING IS NOT REQUIRED. IF NEW SIGNS ARE NOT COVERING THE WALL PATCH, WALLS SHALL BE PAINTED TO COVER THE PATCH. THE PAINT COLOR SHALL MATCH EXISTING WALL COLOR. IT IS NOT REQUIRED TO PAINT THE ENTIRE WALL. PAINT ONLY A 2" BORDER AROUND THE SIGN. SEE PAINT SCHEDULE DETAIL 3 ON SHEET A506A.

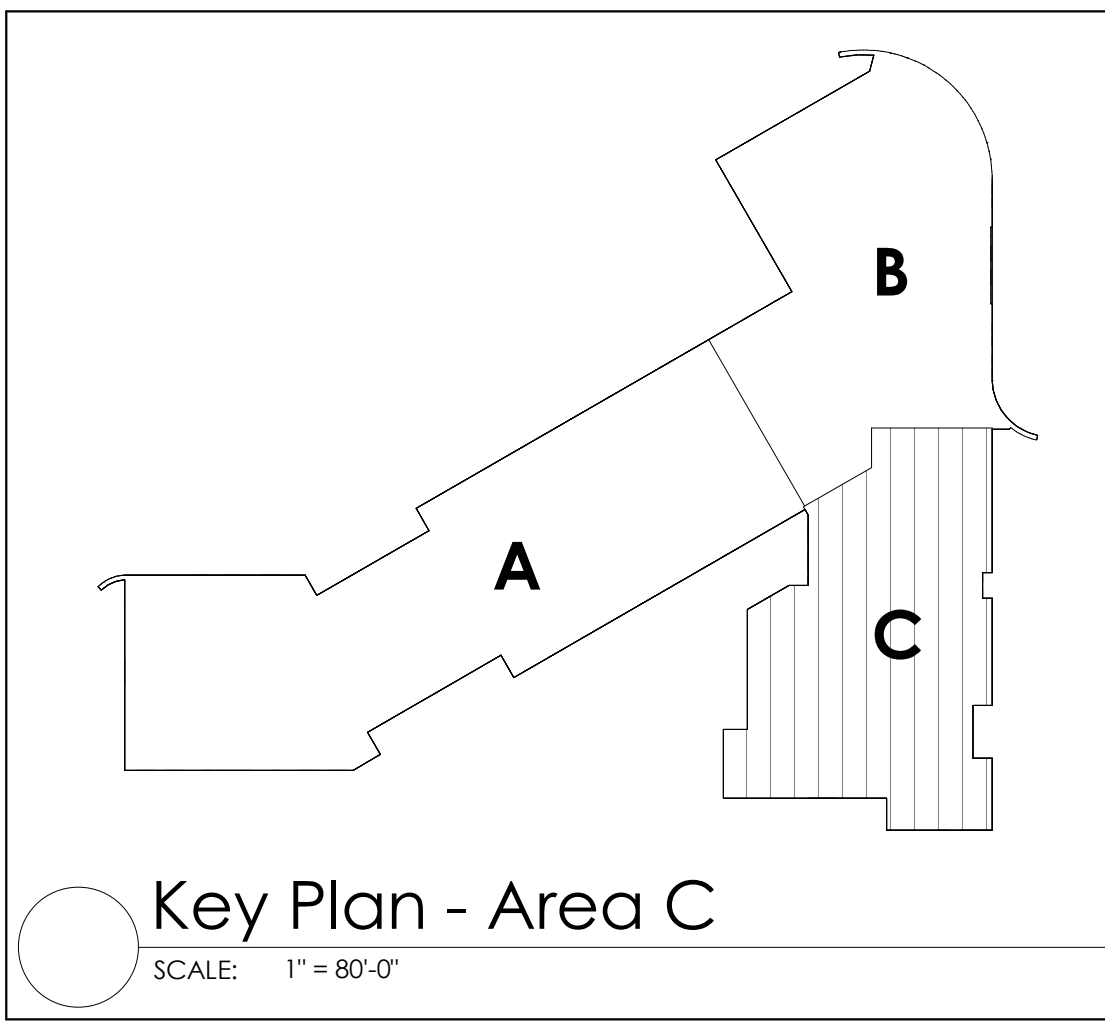

Key Plan - Area C

SCALE: 1" = 80'-0"

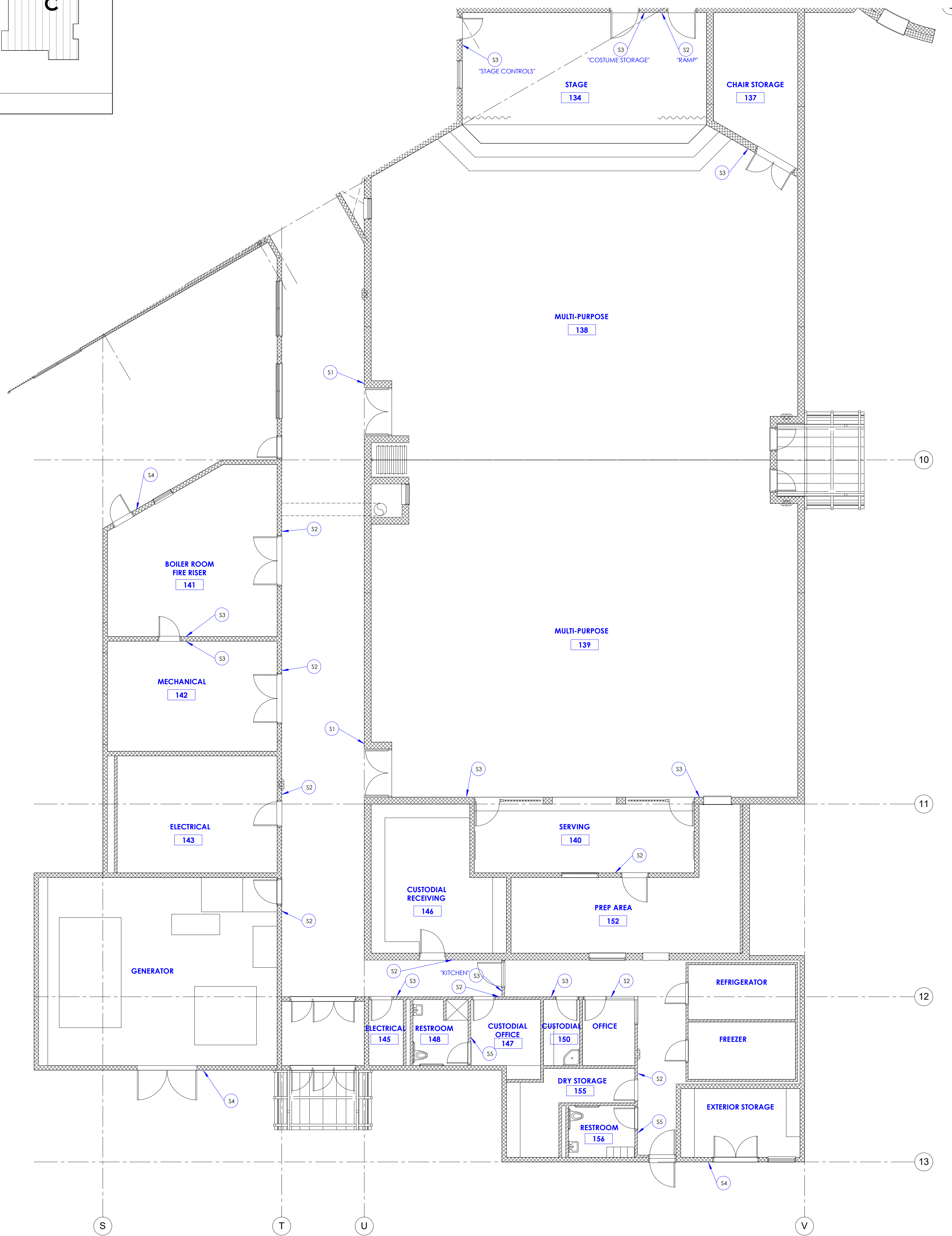

1 Floor Plan Level 1 Area C

SCALE: 1/8" = 1'-0"

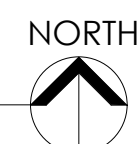

NJRA Architects, Inc.
5223 S. Ascension Way, Suite 350
Murray, Utah 84123
801.364.9259
www.njraarchitects.com

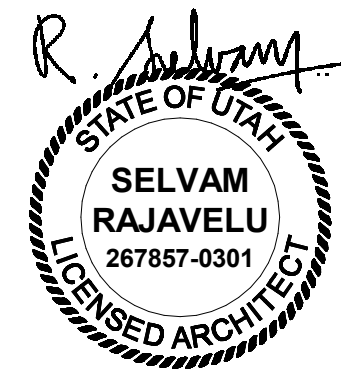

Salt Lake City School District
Backman Elementary School
Signage

601 N 1500 W
Salt Lake City, Utah 84116

NJRA Project # 24726.00
Construction Documents Feb 14, 2025

Floor Plan
Level 1 - Area
C

A110C

GENERAL NOTES

- A. REMOVE ALL EXISTING WALL-MOUNTED PANEL SIGNS IN THE BUILDING (NOT SHOWN ON THESE PLANS). VERIFY EXISTING SIGN LOCATIONS AND QUANTITIES IN THE FIELD PRIOR TO PREPARING BIDS.
- B. VERIFY BUILDING CONDITIONS IN THE FIELD. IF THERE IS A CONFLICT WITH SIGN TYPE OR SIGN LOCATION AS SHOWN IN THESE PLANS, COORDINATE WITH THE ARCHITECT AND OWNER'S REPRESENTATIVE FOR AN ALTERNATE SOLUTION.
- C. SEE SIGN TYPE DETAIL (DETAIL 1/A506A) FOR ALL TYPICAL SIGN TYPES (S1-S6).
- D. SEE SIGN MOUNTING DETAIL (DETAIL 2/A506A) FOR LOCATION OF SIGN IN RELATION TO DOOR OR OPENING. COMPLY WITH ADA FOR ALL MOUNTING LOCATIONS. IF SIGN OCCURS ON A WINDOW OR DOOR SIDELIGHT, MOUNT WITH ADHESIVE AND PROVIDE BACK-UP SHAPE ON OPPOSITE SIDE OF GLASS. IF SIGN LOCATION SHOWN CONFLICTS WITH A BUILDING ELEMENT, COORDINATE WITH THE ARCHITECT AND OWNER'S REPRESENTATIVE FOR AN ALTERNATE LOCATION.
- E. EXISTING SIGN IN SOME AREAS ARE MOUNTED ON GYPSUM BOARD AND MASONRY WALLS WITH FASTENERS (SCREWS, METAL INSERTS, PLASTIC INSERTS, TOGGLE BOLTS, ETC.). WHERE EXISTING SIGNS ARE BEING REPLACED WITH NEW SIGNS, REMOVE ALL EXISTING FASTENERS AND PATCH HOLES ON GYPSUM BOARD WALLS AND MASONRY WALLS AS REQUIRED. IN MOST PLACES, NEW SIGNS SHALL COVER THE PATCHED HOLES AND PAINTING IS NOT REQUIRED. IF NEW SIGNS ARE NOT COVERING THE WALL PATCH, WALLS SHALL BE PAINTED TO COVER THE PATCH. THE PAINT COLOR SHALL MATCH EXISTING WALL COLOR. IT IS NOT REQUIRED TO PAINT THE ENTIRE WALL. PAINT ONLY A 2" BORDER AROUND THE SIGN. SEE PAINT SCHEDULE DETAIL 3 ON SHEET A506A.

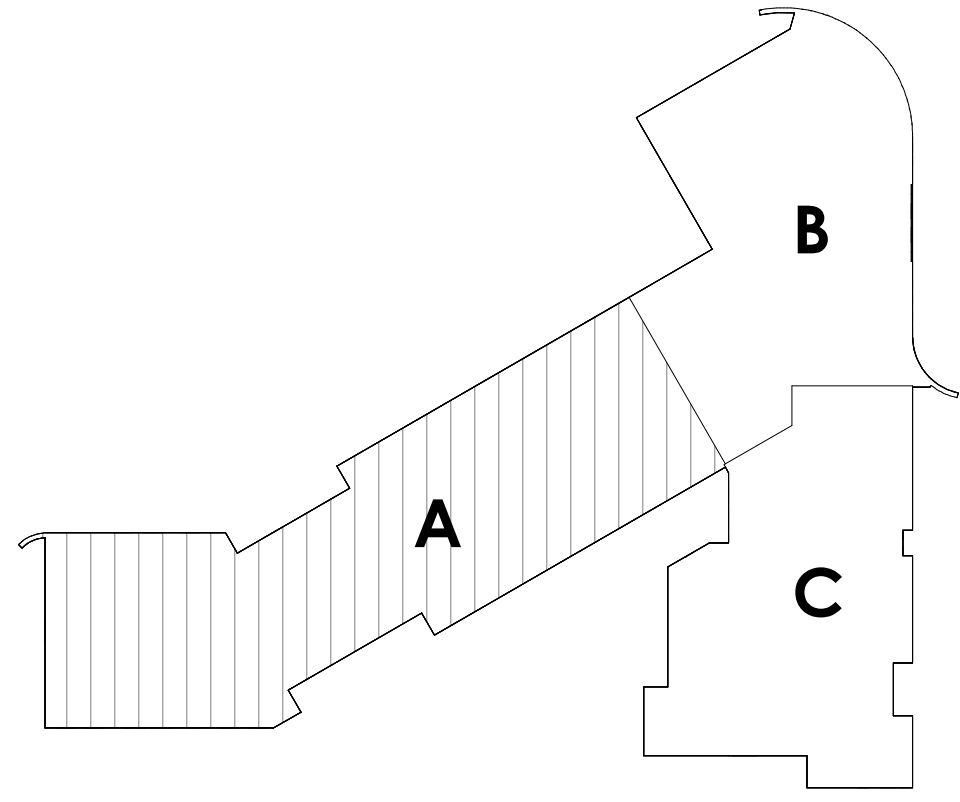

Key Plan - Area A

SCALE: 1" = 80'-0"

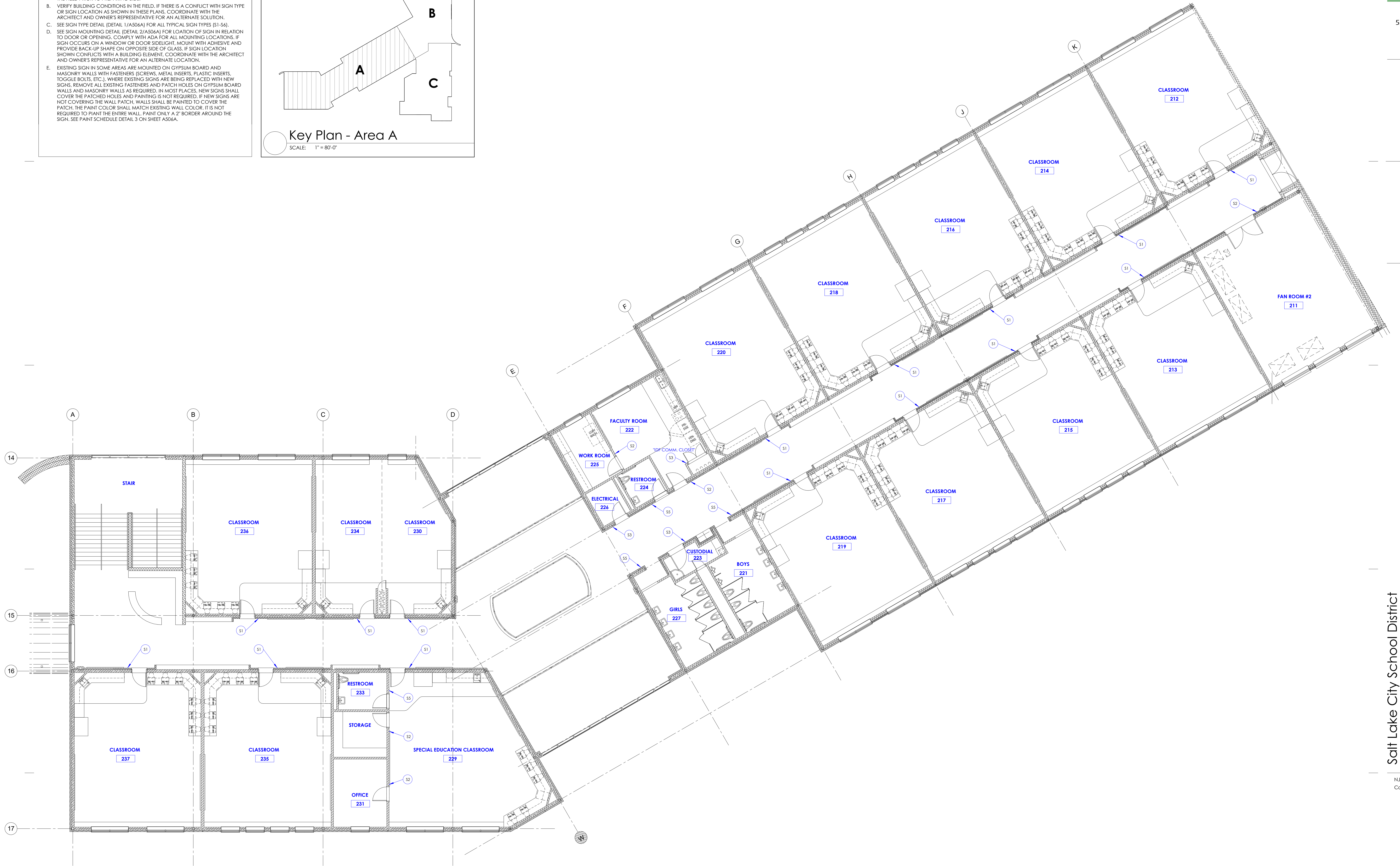

Salt Lake City School District
Backman Elementary School
Signage

601 N 1500 W
Salt Lake City, Utah 84116

NJRA Project # 24726.00
Construction Documents Feb 14, 2025

Floor Plan
Level 2 Area
A

A120A



2 Floor Plan Level 2 - Overall

SCALE: 1/8" = 1'-0"

2/19/2025 3:11:01 PM

- GENERAL NOTES**
- A. REMOVE ALL EXISTING WALL-MOUNTED PANEL SIGNS IN THE BUILDING (NOT SHOWN ON THESE PLANS). VERIFY EXISTING SIGN LOCATIONS AND QUANTITIES IN THE FIELD PRIOR TO PREPARING BIDS.
- B. VERIFY BUILDING CONDITIONS IN THE FIELD. IF THERE IS A CONFLICT WITH SIGN TYPE OR SIGN LOCATION AS SHOWN IN THESE PLANS, COORDINATE WITH THE ARCHITECT AND OWNER'S REPRESENTATIVE FOR AN ALTERNATE SOLUTION.
- C. SEE SIGN TYPE DETAIL (DETAIL 1/A506A) FOR ALL TYPICAL SIGN TYPES (S1-S6).
- D. SEE SIGN MOUNTING DETAIL (DETAIL 2/A506A) FOR LOCATION OF SIGN IN RELATION TO DOOR OR OPENING. COMPLY WITH ADA FOR ALL MOUNTING LOCATIONS. IF SIGN OCCURS ON A WINDOW OR DOOR SIDELIGHT, MOUNT WITH ADHESIVE AND PROVIDE BACK-UP SHAPE ON OPPOSITE SIDE OF GLASS. IF SIGN LOCATION SHOWN CONFLICTS WITH A BUILDING ELEMENT, COORDINATE WITH THE ARCHITECT AND OWNER'S REPRESENTATIVE FOR AN ALTERNATE LOCATION.
- E. EXISTING SIGN IN SOME AREAS ARE MOUNTED ON GYPSUM BOARD AND MASONRY WALLS WITH FASTENERS (SCREWS, METAL INSERTS, PLASTIC INSERTS, TOGGLE BOLTS, ETC.). WHERE EXISTING SIGNS ARE BEING REPLACED WITH NEW SIGNS, REMOVE ALL EXISTING FASTENERS AND PATCH HOLES ON GYPSUM BOARD WALLS AND MASONRY WALLS AS REQUIRED. IN MOST PLACES, NEW SIGNS SHALL COVER THE PATCHED HOLES AND PAINTING IS NOT REQUIRED. IF NEW SIGNS ARE NOT COVERING THE WALL PATCH, WALLS SHALL BE PAINTED TO COVER THE PATCH. THE PAINT COLOR SHALL MATCH EXISTING WALL COLOR. IT IS NOT REQUIRED TO PAINT THE ENTIRE WALL. PAINT ONLY A 2" BORDER AROUND THE SIGN. SEE PAINT SCHEDULE DETAIL 3 ON SHEET A506A.

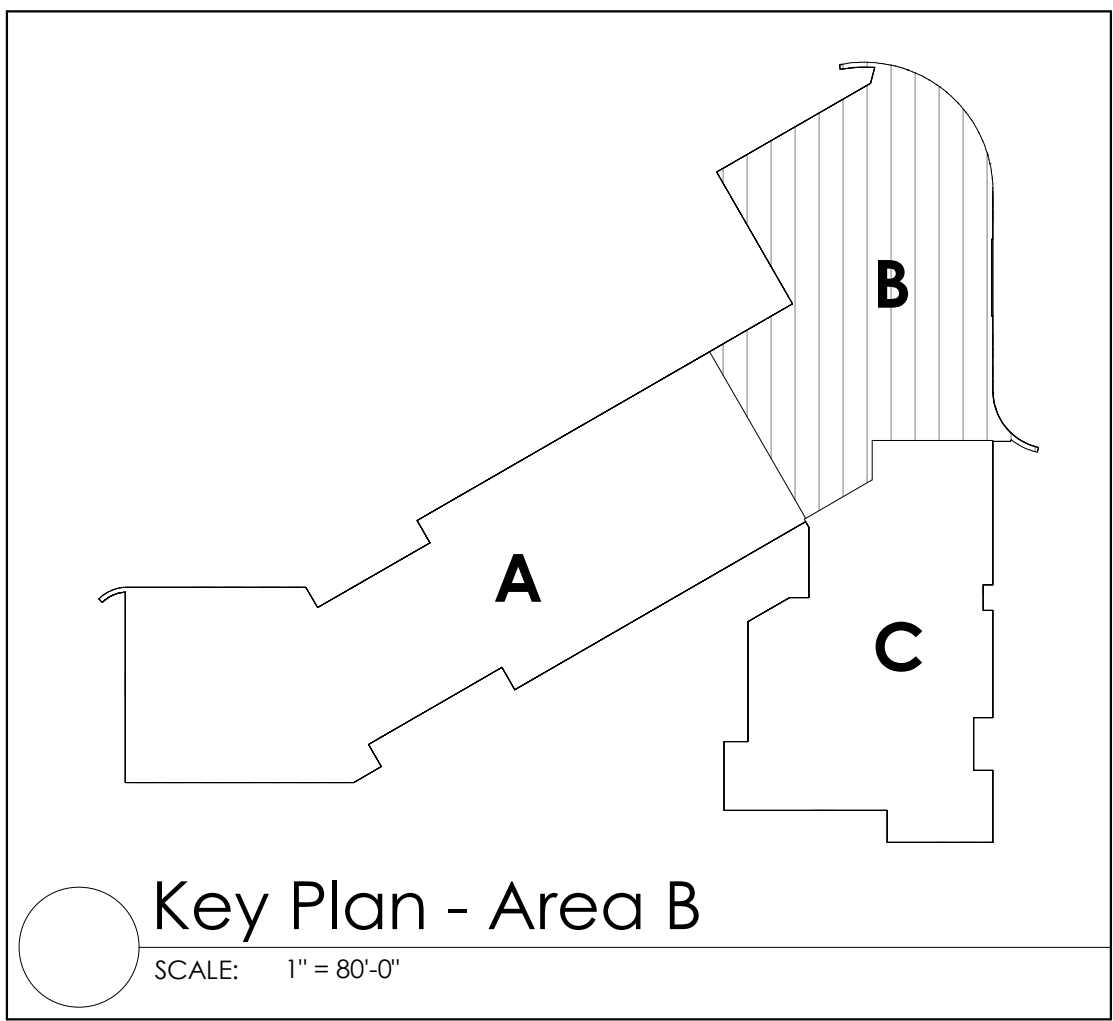

1 Floor Plan Level 2 Area C
SCALE: 1/8" = 1'-0"

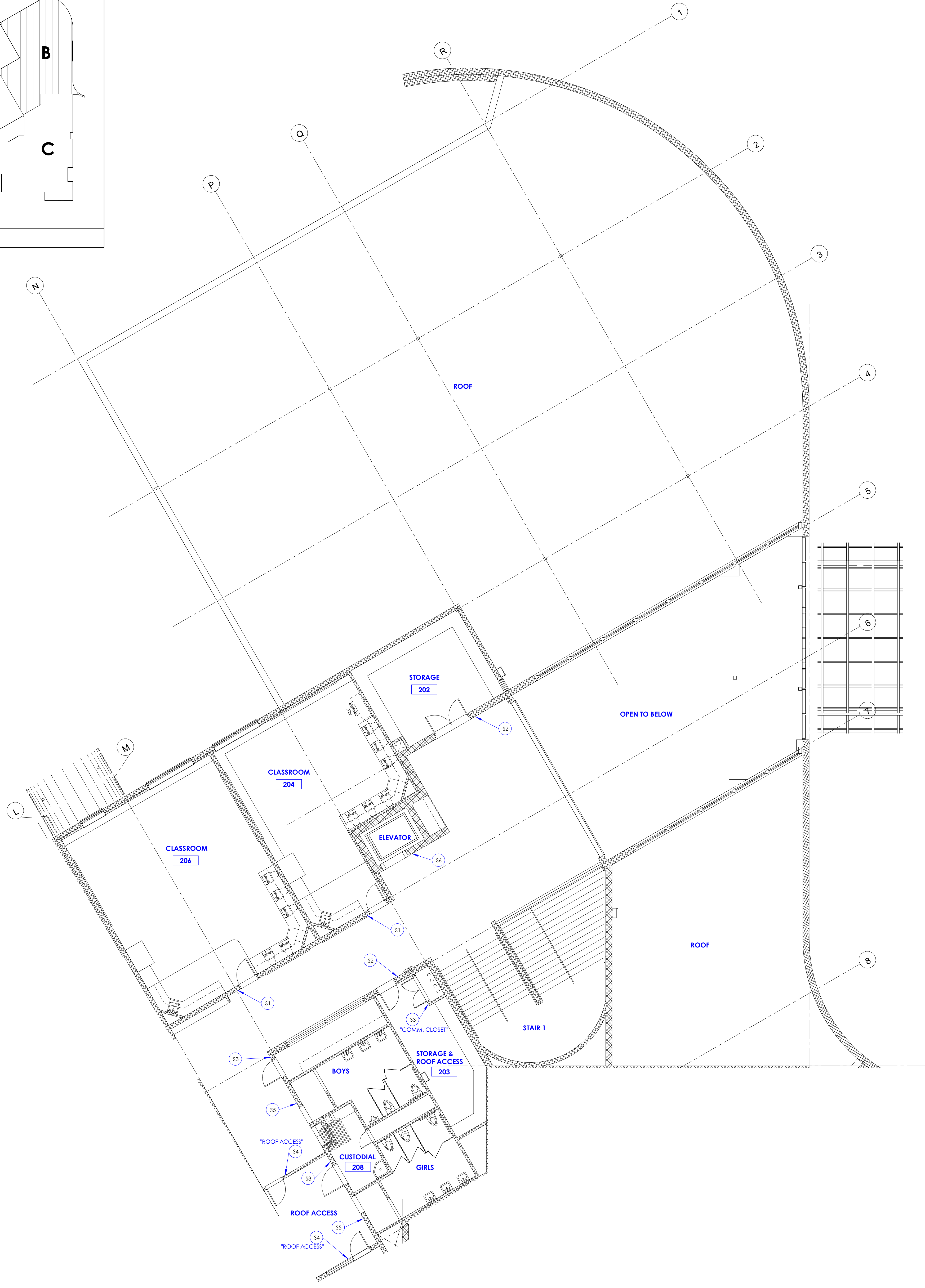

NJRA Architects, Inc.
5223 S. Ascension Way, Suite 350
Murray, Utah 84123
801.364.9259
www.njraarchitects.com

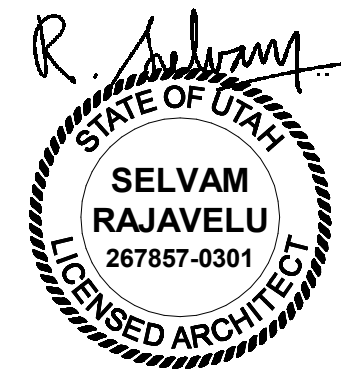

Salt Lake City School District
Backman Elementary School
Signage

601 N 1500 W
Salt Lake City, Utah 84116

NJRA Project # 24726.00
Construction Documents Feb 14, 2025

Floor Plan
Level 2 - Area
B

A120B

KEYED NOTES

- "SLIDE" MODULAR SIGN BY 2/90 SIGN SYSTEMS WITH STANDARD STRUCTURAL RAILS.
- SQUARE CORNER END CAPS, TYP. IN NATURAL ANODIZED ALUMINUM FINISH.
- SPACE FOR INSERT.
- PROVIDE APPROPRIATE SYMBOL FOR MEN, WOMEN, STAFF (MEN & WOMEN), AND RESTROOM (MEN & WOMEN) TOILET ROOM AS OCCURS.
- BRAILLE CHARACTERS PER A.D.A. (AMERICANS WITH DISABILITIES ACT) REQUIREMENTS, DENOTING ROOM NUMBER AND NAME.

- NOTE:
- IF SIGN LOCATION OCCURS AT A WINDOW OR SIDELIGHT, MOUNT ON GLASS AND PROVIDE BACK-UP SHAPE ON OPPOSITE SITE OF GLASS.
 - PROVIDE TAMPER RESISTANT SCREWS ON THE SIGN FRAMES.
 - SIGNS ARE TO BE MOUNTED MECHANICALLY WITH SCREWS AND ANCHORS (NO DOUBLE STICK TAPE, EXCEPT FOR WINDOWS).

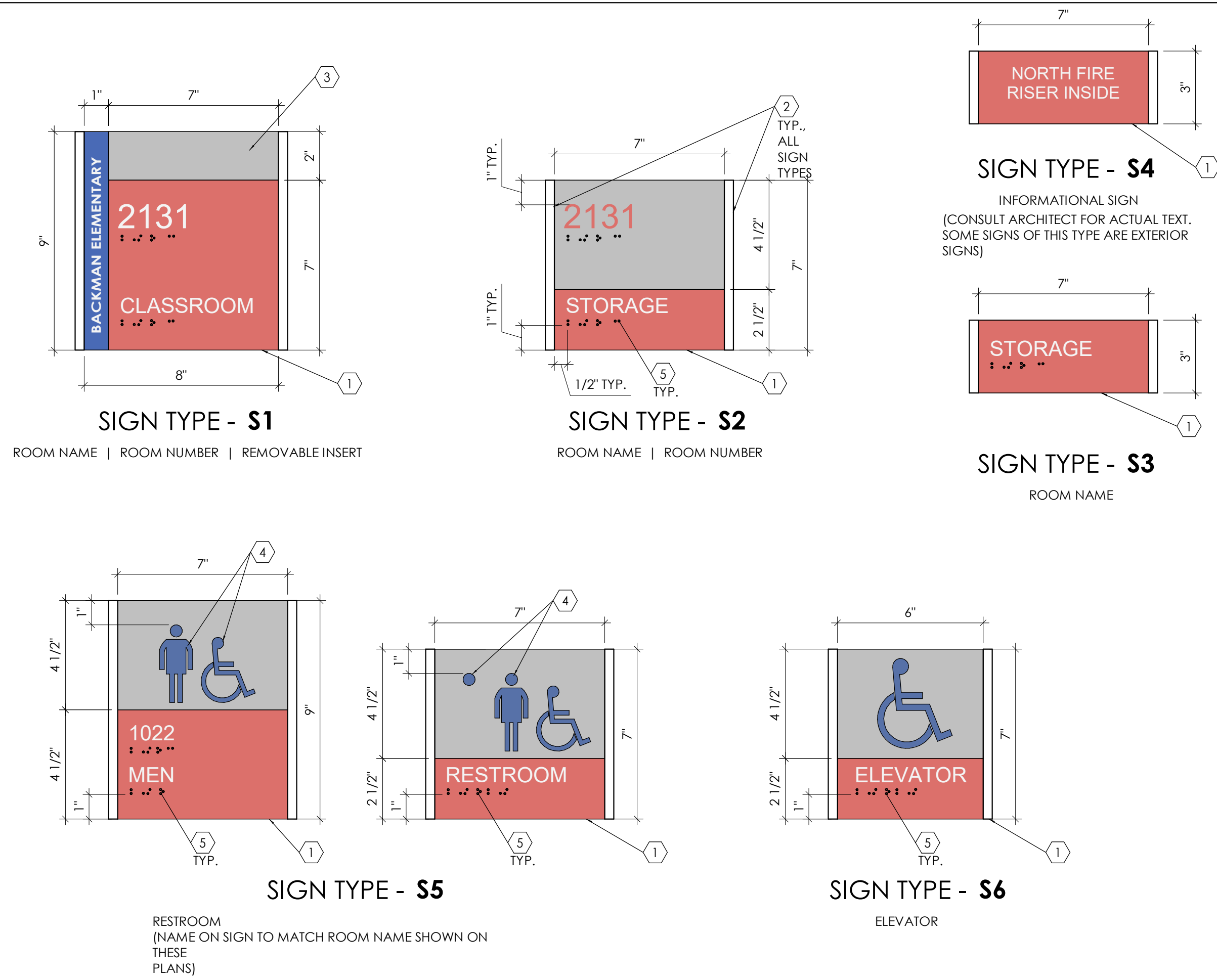

1 Signage Types
SCALE: 3" = 1'-0"

KEYED NOTES

- SIGN TYPE S1-S5 AS SHOWN ON OVERALL FLOOR PLANS.
- LINE OF FLOOR.
- DOOR FRAME.
- DOOR.
- OPENING IN WALL.

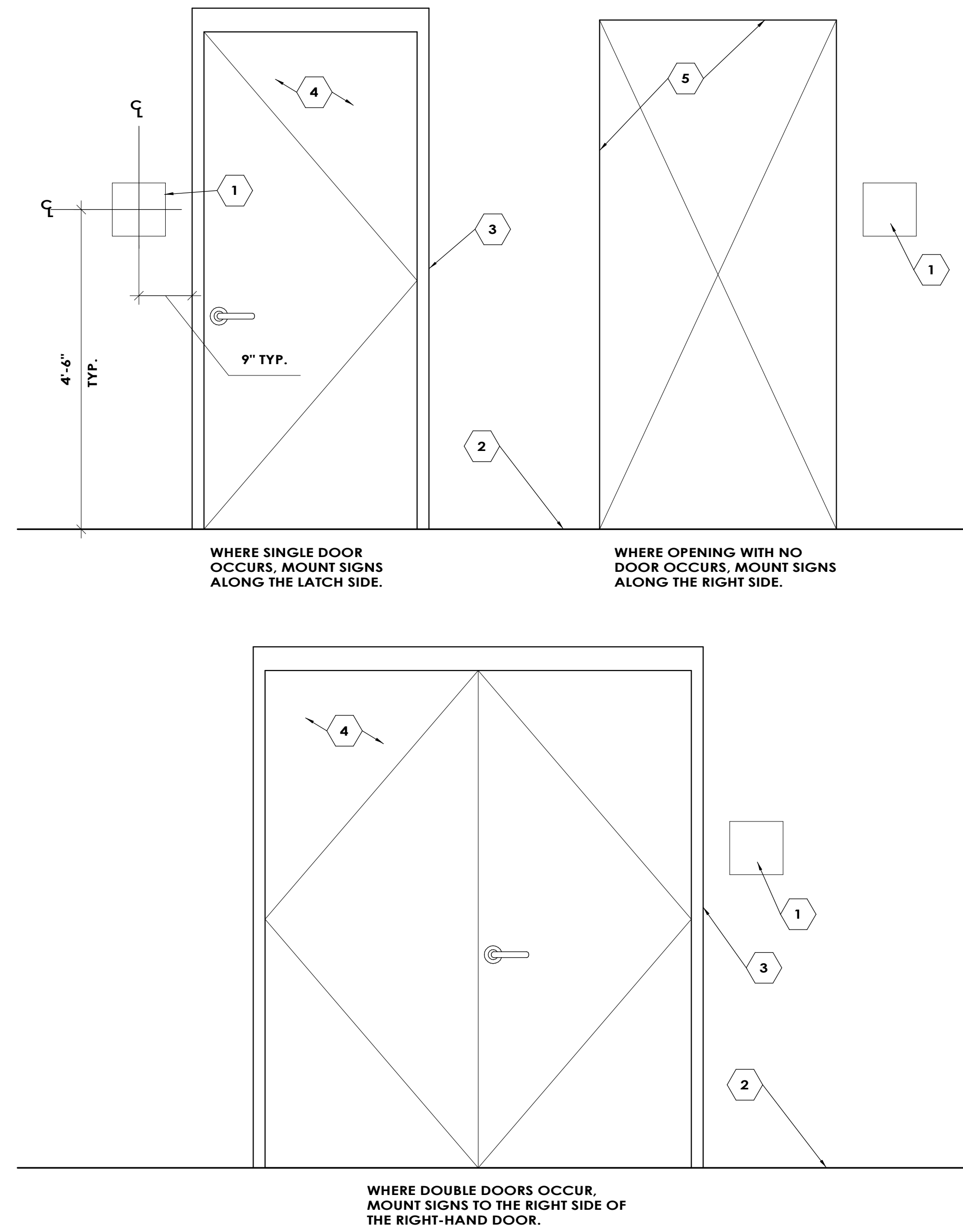

2 Sign Mounting Detail
SCALE: 3/4" = 1'-0"

| | | | | | | | | | | | | |
|-----|---------|-----------------------|--------------------------|----------------|-------------------------|---------|------------|-----------------------------------------------|---|---|--|--|
| 104 | BACKMAN | Walls | BACKMAN WALLS | Benjamin Moore | Ultra Spec 500 Interior | N538-1X | EGGSHELL | Y3 0X1.75, S1 0X3.00, W1 0X27.00 | X | X | | |
| | | Accent Walls | BACKMAN BLUE ACCENT | Benjamin Moore | Ultra Spec 500 Interior | N539-3X | SEMI-GLOSS | S1 3X15.00, W1 0X0.00, M1 1X16.00, B1 4X22.00 | X | X | | |
| | | Accent Walls | BACKMAN GRAY ACCENT | Benjamin Moore | Ultra Spec 500 Interior | N538-1X | EGGSHELL | Y3 0X3.50, S1 1X15.00, B1 0X2.00 | X | X | | |
| | | Walls | BACKMAN CAFETERIA RED | Benjamin Moore | Ultra Spec 500 Interior | N540-4X | GLOSS | S1 1X22.50, W1 0X14.00, M1 6X25.25, R3 3X2.25 | X | X | | |
| | | Walls | BACKMAN HALL WALLS | Benjamin Moore | Ultra Spec 500 Interior | N538-1X | EGGSHELL | Y3 0X6.00, S1 0X3.75, S2 0X2.0 | X | X | | |
| | | Walls | BACKMAN BATHROOMS | Benjamin Moore | Ultra Spec 500 Interior | N538-1X | EGGSHELL | Y3 0X3.50, S1 0X3.50 | X | X | | |
| | | Hallway feature | BACKMAN HALLWAY FEATURES | Benjamin Moore | Ultra Spec 500 Interior | T537-3X | EGGSHELL | S1 1X5.00, W1 1X12.00, M1 2X22.00, R3 1X28.00 | | | | |
| | | Interior Doors/Frames | BACKMAN INT DOORS/FRAMES | Benjamin Moore | ADVANCE | 0792-4X | SATIN | S1 1X15.25, M1 7X3.50, R3 3X1.25 | X | X | | |
| | | Exterior Doors/Frames | BACKMAN EXT DOORS/FRAMES | Benjamin Moore | ADVANCE | 0793-4X | SEMI-GLOSS | S1 1X31.00, W1 0X0.00, M1 6X14.00, R3 4X5.00 | X | X | | |

3 Paint Schedule
SCALE: 3" = 1'-0"