



**KMA ARCHITECTS, INC.**  
170 N Main Street  
Spanish Fork, UT 84660  
(801) 377- 5062

[kmaarchitects.com](http://kmaarchitects.com)

May 6, 2025

Addendum No. 1

**ADDED TO THE PLANS AND SPECIFICATIONS FOR**  
**ALTARA ELEMENTARY SCHOOL REMODEL**

TO ALL SUBCONTRACTORS SUBMITTING BIDS ON THE ABOVE PROJECT: This **Addendum No. 1** of Architectural, Plumbing, Mechanical and Electrical is hereby made a part of the Contract Documents pertaining to the above project and shall be binding upon each Contractor submitting bid. It shall be the responsibility of each Contractor to notify his subs and suppliers concerning the contents of this Addendum as they specifically apply to them.

**ITEM 1.** The bid date is Wednesday May 12, 2025 **at 2:00 pm** (Submit to Canyon School District).

**ITEM 2.** Contractor to patch and repair any roof penetrations during construction per district standards and to match existing materials.

**ITEM 3.** The following image defines which existing walls are framed and which are masonry.

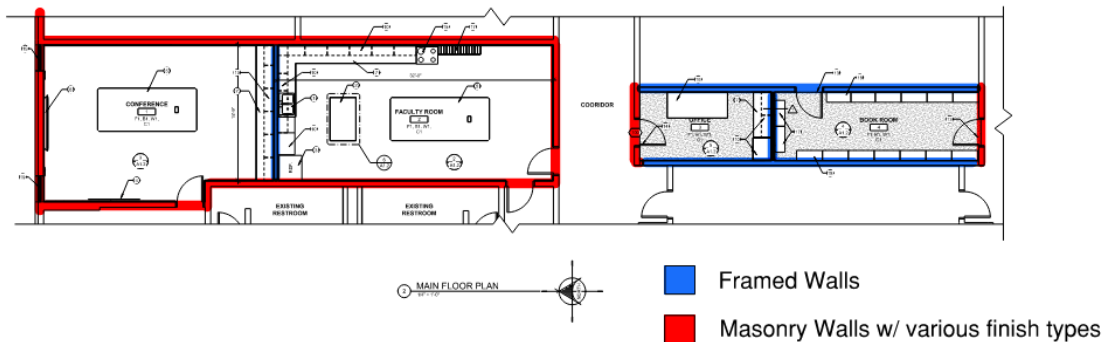

**SEE THE FOLLOWING LIST FOR APPROVED SUBSTITUTIONS / ITEMS:**

N/A

**SEE THE FOLLOWING SHEETS FOR CONSULTANT ADDENDUM ITEMS:**

1. O&P Addendum #1
2. Resolut Addendum #1

**ADDENDUM #1**

May 6, 2025

TO THE PLANS AND SPECIFICATIONS FOR THE:

CANYON SCHOOL DISTRICT  
ALTARA ELEMENTARY REMODEL  
IN SANDY, UTAH

TO ALL CONTRACTORS SUBMITTING BIDS ON THE ABOVE PROJECT: This addendum is hereby made a part of the Contract Documents pertaining to the above project and shall be binding upon each Contractor submitting bids. It shall be the responsibility of each Contractor to notify his sub-contractors and suppliers concerning the contents of this Addendum as they specifically apply to them.

**CHANGES TO THE DRAWINGS:**

N/A

**CHANGES TO THE SPECIFICATIONS:**

N/A

**APPROVED MANUFACTURERS' PRODUCTS:**

The following manufacturers, trade names, and products are approved with the provision that they shall completely satisfy all and every requirement of the Drawings, Specifications, and all Addenda, and shall conform to the design, quality, and standards specified, established, and required for the complete and satisfactory installation and performance of the building and all its respective parts.

<u>PRODUCT</u>	<u>MANUFACTURER</u>
Exhaust Fan	ACME Fan
Diffuser	Nailor Industries
Grille	Nailor Industries

**CLARIFICATION TO THE BIDDERS:**

**CHANGES TO THE SPECIFICATIONS:**

**CHANGES TO THE DRAWINGS:**

**SHEET E1.1 [ELECTRICAL SYMBOLS AND NOTES]**

1. In Abbreviations Index, add 'O.F.O.I. – OWNER FINISH, OWNER INSTALL'.

**SHEET E1.2 [ELECTRICAL SCHEDULES]**

1. EXISTING PANELBOARD 'H' SCHEDULE, CKT. #21: Utilize spare breaker and Add a new breaker with load description of "Ice Machine & Dishwasher", Amps = 20A, Pole = 1, Wire Size = #12.
2. LIGHTING CONTROL INTENT NARARTIVE: Under 'BOOK ROOM'/ Occupancy, reword from 'DAYLIGHT LEVEL' to 'FULL LEVEL'.

**SHEET E3.1 [DEMOLITION PLANS]**

1. View 1, BOOK ROOM 4: Disconnect and remove the existing 3-way light switch and put that on demolition layer.
2. View 2, BOOK ROOM 4: Move note 'D15' closer to the light fixture existing to remain.

**SHEET E4.1 [LIGHTING PLAN & ELECTRICAL PLANS]**

1. View 1, BOOK ROOM 4: Provide a new 3-way switch to the existing switch location on the east wall/side of the room. Extend wiring as required.
2. View 2, CONFERENCE 1: Provide a new GFCI power receptacle for UC refrigerator on east-north wall of the room and connect to nearest receptacle. Height to be coordinated with millwork shop drawings.
3. View 2, FACULTY ROOM 2: Provide a new GFCI power receptacle for dishwasher on west wall of the room and connect to existing panel 'H' circuit #21. Height to be coordinated with millwork shop drawings.
4. View 2, FACULTY ROOM 2: Provide a new GFCI power receptacle for ice machine on west wall of the room and connect to existing panel 'H' circuit #21. Height to be coordinated with millwork shop drawings.

## CYD ALTARA ES REMODEL

### Electrical Addendum #1

Issue Date: 05/06/2025

#### [PRIOR APPROVAL OF MANUFACTURERS OF ELECTRICAL EQUIPMENT

The following items, trade names, products and manufacturers are approved for bidding. Approval does not relieve the bidder from satisfying the intent of the requirements of drawings, specifications and addenda in every respect. Failure to conform to the design quality and standards specified, established and required may result in later disapproval. If equipment must be disapproved after bidding, supplier shall supply specified equipment at no extra cost to the Owner.

Items are listed generally and specific model number, etc. shall be as submitted. Items submitted but not approved, either did not satisfy the requirements, or showed insufficient data, or arrived after the 8 day deadline established for submittals.

<u>TYPE</u>	<u>SPECIFIED</u>	<u>BUILD26 APPROVED</u>	<u>JRC APPROVED</u>	<u>SSCO APPROVED</u>	<u>QUANTUM APPROVED</u>
A4H	METALUX	ILP	MAXLITE	DAY-BRITE CFI	METALUX

END OF ELECTRICAL ADDENDUM